

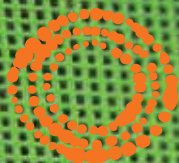

The logo consists of the text "Arts IN HEALTH CARE" in white, stacked vertically. "Arts" is the largest word, "IN" is smaller and centered below it, and "HEALTH CARE" is the same size as "IN" and centered below that. The text is set against a solid orange square background.

Arts
IN
HEALTH
CARE



UK ARTS IN HEALTHCARE
a self-guided tour



Welcome to the UK Albert B. Chandler Hospital, a place that is uniquely Kentucky because of the architecture, landscaping, art and music. It is the goal of the UK Arts in HealthCare Program to make every visitor, patient and staff member feel comfortable and at home; and it is the work of the art to complement and enhance the healing environment.

Take your time and stroll the halls and public spaces and discover art in its many forms, from swooping sculpture, gentle landscapes, dramatic abstracts to whimsical folk art, there is surely something that will bring a smile, a sense of comfort or an escape to a calmer place.

If you have questions or would like further information about the UK Arts in HealthCare program, please contact Jackie Hamilton, 859-257-5528 or jacqueline.hamilton@uky.edu.



“Our mission is to create an environment of care and to focus on the spiritual and emotional well-being of our patients, families, caregivers and staff. The program recognizes the arts and the artists as powerful and positive forces in the healing process.”

*The University of Kentucky
Arts in HealthCare Committee,
a volunteer community advisory council*

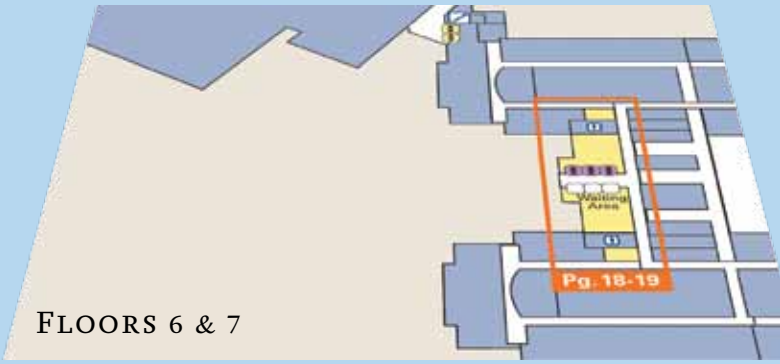

Public Elevators



Stairs

Ground Floor

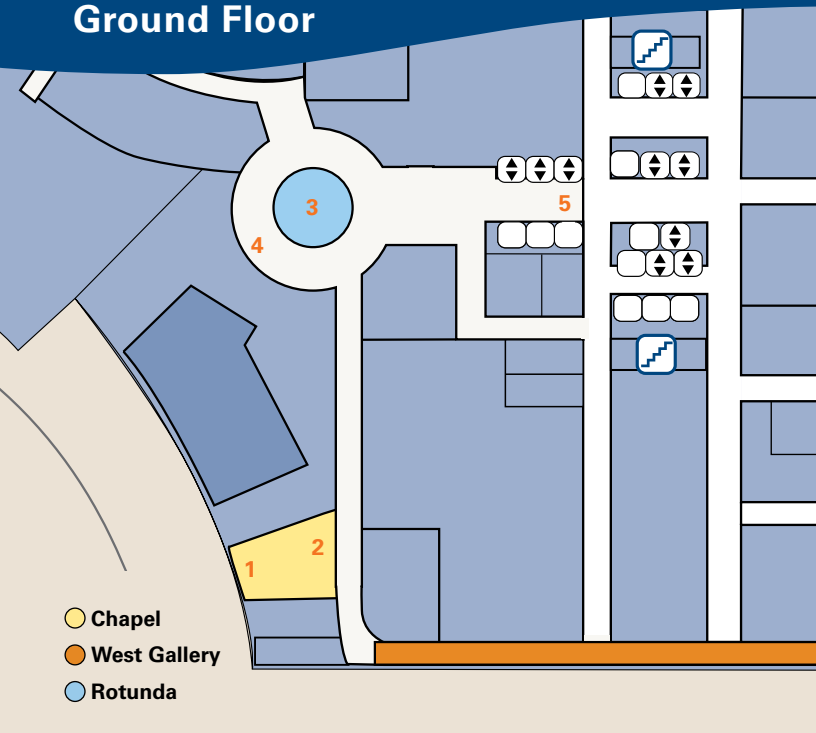

CHAPEL



1. Springtime in Kentucky,
Glass and paint
John Reyntiens, London,
England
Gift from Myra Leigh Tobin

Selected from over 60
artist submissions, John
Reyntien's vision of

springtime in Kentucky captures the spirit of rebirth and hope. He used organic materials to inform the design of the glass and infuse it with a dynamic energy and unpredictable line.

2. Lalibela I & II, *Acrylic on paper with nonpigment and pigment additives*
Peter Gooch, Louisville, Kentucky
Gift from the Estate of Charles L. and Alice K. Hobson

Inspired by the light and the natural and historical beauty of sub-Saharan Africa, Peter created a series of pieces that pay homage to the 17th century frescos at the monastery of Narga Selassie.

WEST GALLERY

One of two rotating gallery spaces in the pavilion, the West Gallery provides 170 feet of wall space to showcase some of Kentucky's most forward-thinking artists. The hope is that these galleries will bring the community to the hospital to see art and hence link the hospital to the cultural landscape.

ROTUNDA



3. Ginkgo, 2011, Painted steel and painted stainless mesh
Warren Seelig, Portland, Maine
Gift from the James F. Hardyman Family Foundation

Warren Seeling was commissioned to create a two-part 32-foot stainless steel sculpture to grace the two and one half-story central atrium skylight. The sculpture's three-dimensional presence and the corresponding shadow fields respond to the challenging dimensions of the rotunda.

"The Ginkgo idea is a metaphor for a positive life force... something growing as a sculptural form... that has a kind of palpable energy" – Warren Seelig

4. Rural Route, 2012

"A Rural Kentucky narrative in the agricultural landscape"
Fresco: Earth pigments & oxides, marble dust, ash and acrylic artist medium
Lynn Sweet, Lexington, Kentucky
Gift from Dr. Andrew and Linda Pearson

Lynn creates figurative landscapes inspired by the writings of Kentucky authors. Sky scripts excerpts with permission from Silas House, *Recruiters*; Wendell Berry, *Nathan Coulter*; Ed McClanahan, *A Congress of Wonders*; Richard Taylor, *Girty*; and Nikky Finney, *Heartwood*.

5. Shady Grove, Mosaic

Guy Kemper, Versailles, Kentucky
A gift in honor of Irv and Irma Rosenstein from their friends Brereton and Elizabeth Jones

Guy created watercolors that referenced the colors and movement of the Kentucky landscape. He worked with Franz Mayer of Munich to translate his paintings into textural mosaics. The lush smalti glass pieces glint with gold and express green in every shade from blue to yellow.

Ground Floor

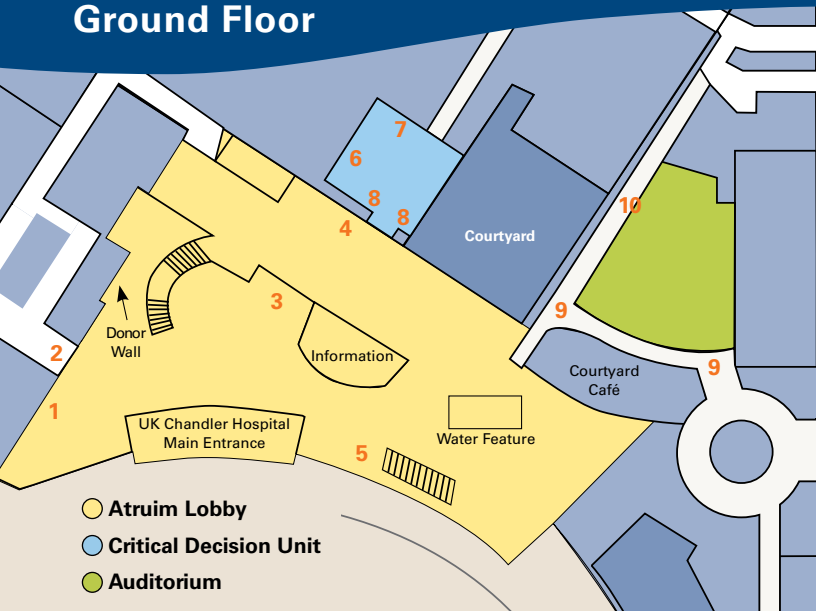

ATRIUM LOBBY

1. Ode to Matisse, PVC pipe, acrylic

Jennie Franz, Lillian, Texas

Gift from John and Glenda Clements and the artist

Reminiscent of Matisse's cut outs, Jennie applies brightly colored shapes to PVC pipe to create dramatic totem poles.



2. Out of the Wailing, Wood, paint and wax

Lavon Williams, Lexington, Kentucky

Gift from grateful patients in honor of Michael Karpf, MD.

Lavon is a former UK

basketball player and renowned folk artist. He works with simple wood carving tools and chisels woodscapes that evoke the rhythm of the south and the soul of jazz in the tradition of his family of carvers.

3. Horse, Wood UK FOLK ART COLLECTION

Charles Keeton, Isonville, Kentucky



4. Luxuriance, Acrylic

Hosook Kang, Brooklyn, New York

Gift from an anonymous donor

Hosook works tirelessly to create a veil of layers in her paintings which lend depth and movement to the finished

piece – the eye is drawn in and beyond the physical expression to a centered place of calmness.

5. Breath, Glass

Frank Close, Lexington, Kentucky

Honoring Dr. Michael and Ellen Karpf from Floyd and Marie Ganassi

Frank works with layered panels of glass and applies slivers of handblown color arranged in a mathematic pattern. The result is a simple mandala that provides a moment of visual respite.

CRITICAL DECISION UNIT

6. Reflections in Yellow and Red, Oil on canvas
Steve Jenkins, Cincinnati, Ohio

Steve captures in paint the warm play of light on the water's surface. Dancing shades of gold, umber and red.

7. Amber Glow, Pastel
Ann Kindl, Lexington, Kentucky

The softness of pastels is the perfect medium to convey the shimmer of fall leaves in the wind.

8. Early September, Mahone Bay, N.S., Oil on panel
Baroque Sunset, Mahone Bay, N.S., Oil on panel
Robert Tharsing, Lexington, Kentucky

Bob and his wife Ann Tower summer in Nova Scotia - he captures the beautiful sunsets off the island in loose slashes of color and light.

AUDITORIUM

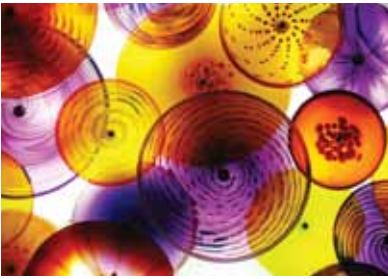

9. Mending Light, Glass, stainless steel and LED lights
Erika Strecker and Tony Higdon, Lexington, Kentucky

Inspired by the custom upholstery in the auditorium, the blown glass floral sconces

in the vestibules reference the bright summer flowers of a Kentucky field.

10. Earthscapes, Acrylic on rusted steel
Mike Elsass, Covington, Kentucky

Mike exposes steel to the elements and then creates landscapes with rich, earth-colored tones.



Floor 1

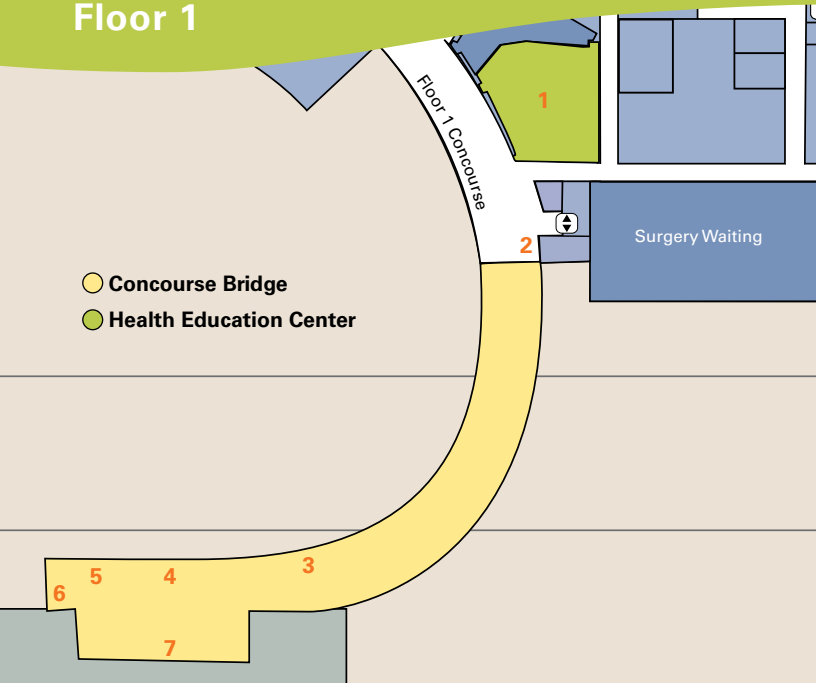

UK FOLK ART COLLECTION

DON & CATHY JACOBS HEALTH EDUCATION CENTER

Working with the Kentucky Folk Art Center in Morehead, Kentucky, UK has accumulated both two-dimensional and three-dimensional pieces from the most important artists in the history of Kentucky folk art. The Don & Cathy Jacobs Health Education Center is the showplace for UK HealthCare's significant folk art collection. In addition to this location, works are placed throughout the hospital.



1. Artists include: *Edgar Tolson, Garland & Minnie Adkins, Elisha Baker, Linvel Barker, Minnie Black, Homer Bowlin, H.A. Brown, JoAnn Butts, Calvin Cooper, Ronald & Jesse Cooper, Ed Mulligan, Hugo Sperger, Helene La France, T.A. Hay, Charley Kinney, Noah Kinney, Golman Crabtree, Joan Dance, Marvin Finn, Denzil Goodpaster, Charles Keeton, Jo Neace Krause, Ed Lambdin, Sherman Lambdin, Tim Lewis, Willie Massey, Carl McKenzie, Ben Miller, Lonnie & Twyla Money, Robert Morgan, Mark Anthony Mulligan, Ernest Patton, Donnie Tolson and Genevieve Wilson.*

"East Kentucky has produced countless folk artists, craftsmen, and traditional and country musicians. The melding of mountain and southern black arts serves as the foundation for much of contemporary American popular culture.

And while we enjoy the products of mountain or rural culture, one should never forget that they were in many ways born out of hard times and brutal lives. In that way, folk art is an optimistic force; it smiles in the face of a callous world. This is one reason that it has had such lasting appeal and such a devoted following."

*—Matt Collinsworth
Director, Kentucky Folk Art Center*

CONCOURSE BRIDGE

2. Monkey with snake and turtle, Painted Wood
Ed Lambdin, Frakes, Kentucky

3. Train, Painted wood, Styrofoam and plastic
Marvin Flynn, Louisville, Kentucky

4. Doorman, Wood, moulding compound, paint and metal
James Allen Bloomfield, McKee, Kentucky

5. Joe Brown as Uncle Sam on stilts, Wood and paint
Carl McKenzie, Nada, Kentucky

6. Sorghum Mill Scene, Painted wood, string and metal chain
Noah Kinney, Toller Hollow, Kentucky

7. Still, Found objects
Robert Morgan, Lexington, Kentucky



See pages 4, 7 and 11 for information on additional pieces of the UK Folk Art Collection.



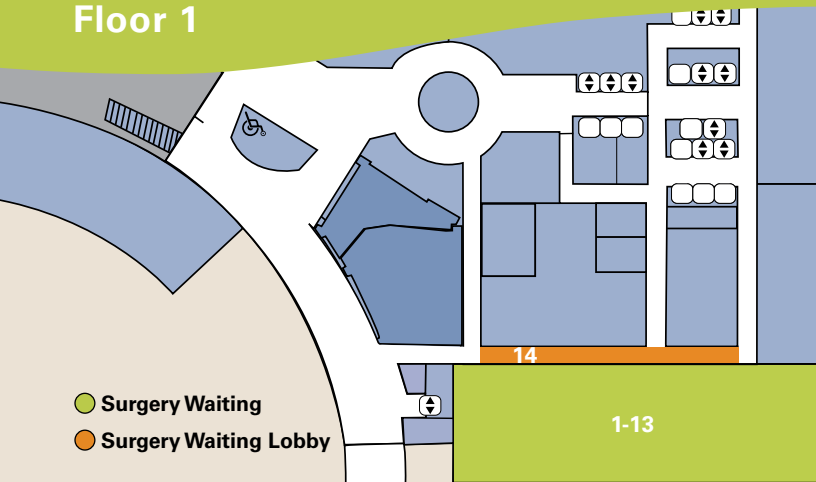

SURGERY WAITING

Surgery Waiting is a showcase for Kentucky artists and artists with a Kentucky connection of significant reputation. In addition, the private consult rooms present intaglios by Takahari, a trompe l'oeil watercolor by Albert Wong and Katie O'Brien's dramatic pastel of her daughter, Mi Lei.



1. Walking Ring, Keeneland, Oil on canvas

Peter Williams, Lexington, Kentucky

Peter Williams paints en plein air and is a standard fixture at Keeneland during the spring and fall meets.

2. Jockey Study in Red and White silks, Pastel

Andre Pater, Lexington, Kentucky

This study is of the artist's son and is on loan from the artist.

3. Leaning Tower of Pizza, Oil on panel

Henry Faulkner, Lexington, Kentucky

Iconic Faulkner, on loan from Heritage Antiques.

4. Hymn (To Her), Acrylic on diabond panels

Richard Bruland, Los Angeles, California

Richard creates hypnotizing layers of swirling paint by using tape, water and extensive sanding.

5. Chandelier, Acrylic on canvas

Rodney Hatfield, Louisville, Kentucky

Gift from Dr. John Thompson

Art Snake, Rodney Hatfield, is a blues musician turned visual artist. He works in many mediums and has many voices. Chandelier is a beautiful and airy example of how he layers and pushes paint.



6. Gaurdians, Fiber Mixed media

Arturo Sandoval, Lexington, Kentucky

Inspired by the upholstery chosen for the space, Sandoval imbued the geometric patterns with orbs of lunminescent ribbon. His work, using found objects from high tech to the mundane, weaves a landscape that challenges the imagination.



7. A Natural History of Kentucky,
2011, Oil on Canvas
Robert Tharsing, Lexington, Kentucky

This painting is a natural history of Kentucky. The large central area represents ancient Kentucky before the influence of man. The scene on the far left depicts a few of the more modern uses of the landscape. Look closely to see the shape of the commonwealth. Tharsing, used painting to provide hope and solace during a personal illness. He was excited to complete this commission to provide the same for waiting families.

8. Pines and Falling Water, *Ink on silk*

9. White Water, *Ink on silk*
Kit Keung Kan, Bethesda, Maryland

The detail of each ink stroke is not apparent until you move in and closely examine the movement and power of the water.

PEDESTALS

10. Handstand, *Bronze*
Tuska, Lexington, Kentucky

A deceased UK fine arts professor, Tuska was fascinated with the beauty and athleticism of the human form.



11. Sultry Healing Glancer
Lascivious Dawning Mania, *Blown glass*
Stephen Powell, Danville, Kentucky

Part of Powell's Screamer series, the pieces strain their long curved necks to the sky in the act of screaming.



12. She Shall be Called Woman, *Wood*
Edgar Tolson, Trent Fork, Kentucky

Edgar Tolson was one of the first Kentucky folk artists to gain national recognition and acknowledgement.

13. Fantasy Castle, *Acrylic on wood*
Steve Armstrong, Lexington, Kentucky
Gift from the locono Family

Once a Montessorri teacher, Steve is fascinated with childlike imagination and mystery. The subtly moving parts of the castle belie the mechanical complexity hidden in the castle base and towers.

SURGERY WAITING HALLWAY

14. Brookfield Farm, *Photography*
David Traxler, Lexington, Kentucky

A retired engineer, David perfects his photography skills on a friend's farm that raises "Black Baldy" cows.

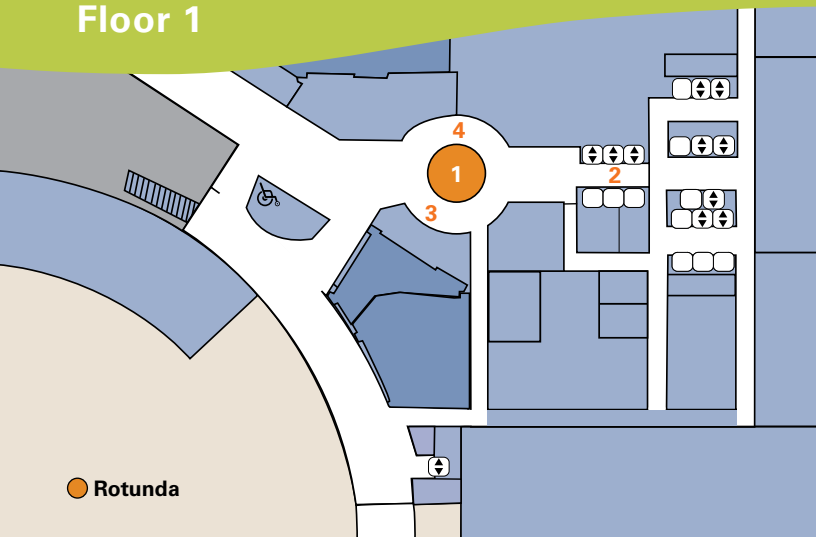

ROTUNDA FLOOR 1

1. Ginkgo (see page 5)
Warren Seelig

2. Sunnyside, Mosaic
Guy Kemper, Versailles, Kentucky

Guy created watercolors that referenced the colors and movement of the Kentucky landscape. He worked with Franz Mayer of Munich to translate his paintings into textural mosaics.

3. Accidental Narratives, Mixed media
Jim Edmon, Lexington, Kentucky

The artist creates a singular world in a 12 x 12" space; the series creates a family of whimsy and childlike expression.



4. Folk Art Walking Sticks **UK FOLK ART COLLECTION**
These canes represent a long tradition in Kentucky folk art – a utilitarian object was created to become a form of self-expression. The art ranges from the reverent to the practical to the whimsical.

"All great academic medical centers rely on philanthropy to achieve their dreams. The generous gifts of individuals and organizations make it possible to bring together art, science and healing in this world-class facility for the people of Kentucky and beyond."

*Michael Karpf, MD
Executive Vice President for Health Affairs*

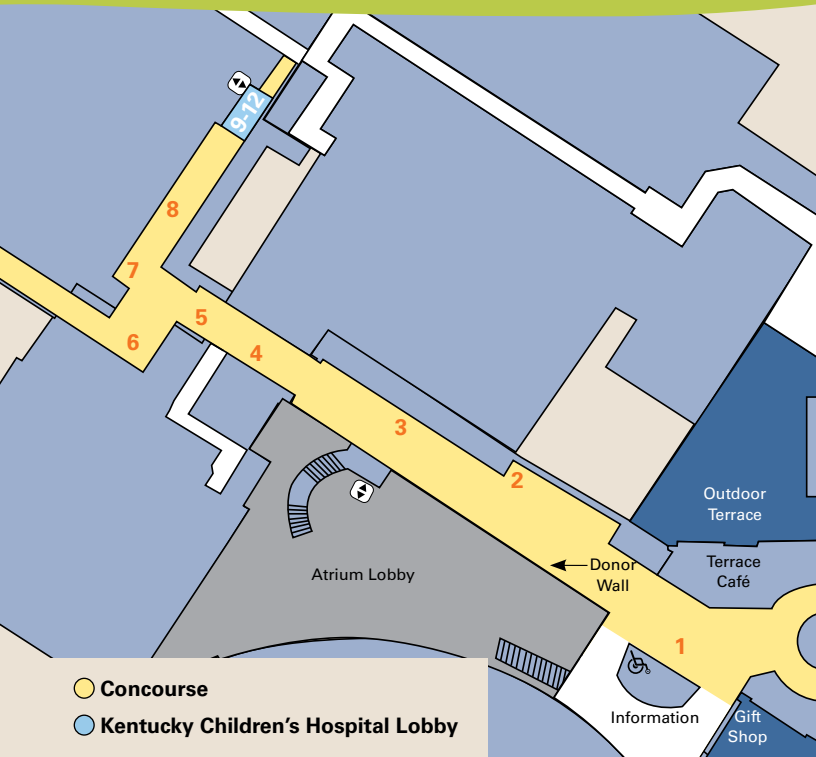

CONCOURSE FLOOR 1

1. Transylvania University

Boasting the first medical department west of the Alleghenies, Transylvania University is partnering with the UK Arts in HealthCare Program and will maintain a rotating display from its medical and scientific artifact collection.



2. Garden of Healing, Garden of Hope, *Mixed media collage Kathleen O'Brien, Harrodsburg, Kentucky*

Garden of Healing, Garden of Hope is a commissioned painting and collage to commemorate the Lucille Caudill Little Performing Arts in HealthCare Program's Second Teresa Garbulinska Annual Premier Performance with guest artist Midori. Each year a piece of art

will be commissioned to celebrate this concert and an annual print created. This work, which includes Japanese papers, botanicals, mica and drawings of healing plants, is cognizant of Midori's emphasis on a green and giving world.

3. Celebrate Kentucky Wall

Photojournalism instructor Tim Broekema from WKU translated the idea to show pictures from across Kentucky into a dynamic and ever-changing multimedia presentation that stops visitors and staff in their tracks. Everyone sees a person, place or object that looks like home and brings a smile.

Floor 1

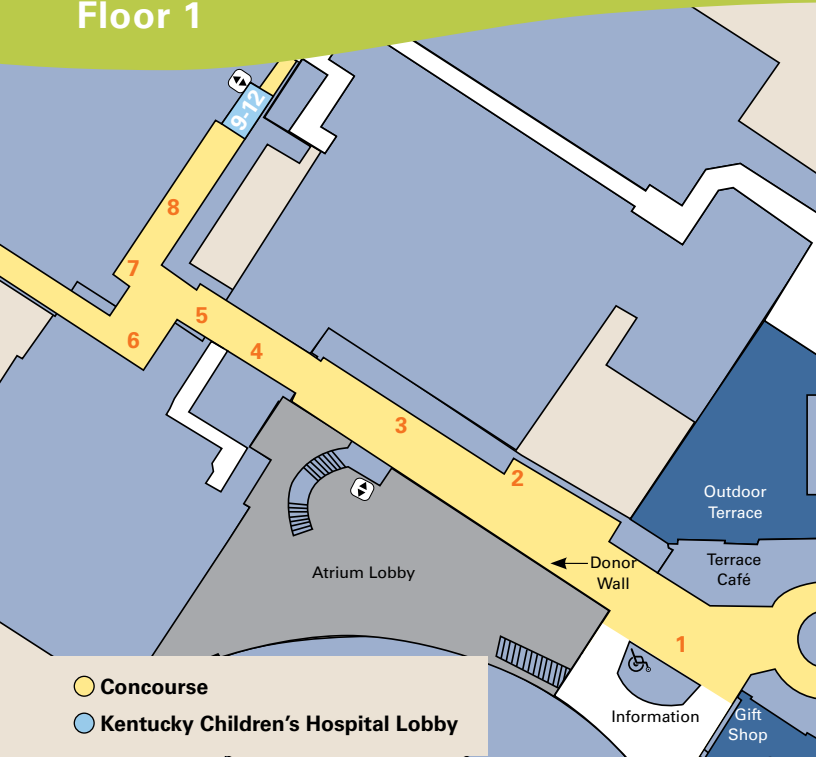

CONCOURSE CONTINUED

4. Hope, Graphite and watercolor on paper
Freedom, Graphite and watercolor on paper
Thornton Dial, Bessemer, Alabama
On loan from the Souls Grown Deep Foundation

Thornton Dial is perhaps the most prolific and renowned of southern vernacular artists – his work is presented by MOMA, the DeYoung and the Frisk.

5. Girl with Pony, Bronze
Unknown
Gift from Dottie and Zeff Maloney in honor of Alden and Georgia Mills Maloney

This gift celebrates the return to good health of the donor's daughter after an equine accident.

6. "Gift of Life"
The Gift of Life wall is dedicated to the memory of those who through organ, eye and tissue donations have given the gift of life, sight and healing to so many. The wall is not inclusive of every individual who made this life-giving decision as some have chosen to remain anonymous.

If you look closely, you will see the undulating currents of a river whose color changes as rays of light dance off its surface. As a river is a source of life-sustaining water, so too these donors have been a source of life for others.

Each year, additional donors are honored and their names added to the wall through a Celebration of Life ceremony.

"We honored our daughter's wishes by donating her organs. Knowing that she lives on in others helps mend our broken hearts."
— Donor family

7. Fields of Purple, Oil on canvas
Ellen Glasgow, Frankfort, Kentucky

Ellen loves to paint en plein air and large – she likes her pieces to convey the bigger than life presence of nature and beauty in the world.

8. East Gallery

The smaller of the two rotating galleries, the East Gallery allows for more dramatic and succinct presentations of artists.

KENTUCKY CHILDREN'S HOSPITAL LOBBY

9. Log a Load for Kids, Wood
J. Daniel Diekhoff, Frankfort, Kentucky

An example of incredible craftsmanship, the wood sculpture was created in two phases. The second phase was completed when the sculpture was moved across the lobby with the opening of Pavilion A.

UK FOLK ART COLLECTION



10. Three types of skunks, Wood
Noah Kinney, Toller Holler, Lewis County, Kentucky



11. Noah's Ark, Acrylic on panel
JoAnn Butts, Sandy Hook, Kentucky

12. American Carnival, Wood
Coopers, Flemingsburg, Kentucky



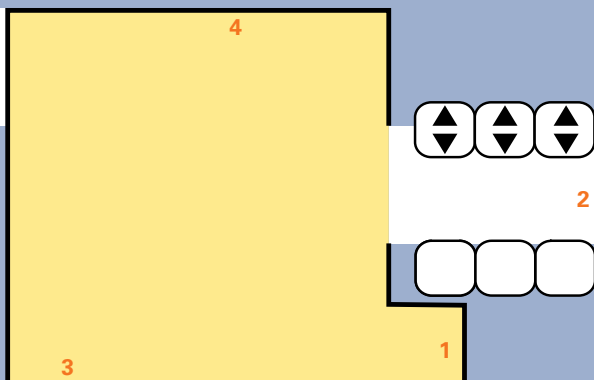

○ PACU Waiting

PACU WAITING

1. Lake Reflection 8, Acrylic on canvas

Jeffrey Vaughn, Alton, Illinois

Jeffrey's works illustrate his fascination with the details of nature – the light and movement of water and sky. Gift from the family, friends, patients, colleagues, residents and staff of Stephen E. Strup, MD, FACS, in honor of his 50th birthday – November 29, 2011.

“Every time I pass by a piece of art it brightens up my day and brings a smile. The art, the music and the landscape make work more pleasant and less stressful.”

UK HealthCare Registered Nurse

SOULS GROWN DEEP FOUNDATION

The Souls Grown Deep Foundation's roots can be traced to the mid-1980s when William Arnett began to collect in earnest the artworks of self-taught African American artists in the southeastern United States. The foundation believes the so-called folk or outsider artists of the black American South were a coherent cultural movement and constituted a crucial chapter in world art. The sweeping changes affecting southern black life in the late 20th century, especially those changes set in motion by the civil rights movement, radically energized the artists of the region and their long-suppressed voices.



2. Bricklayer Quilt, Circa 1973
Margaret Bennett

An example of the Gee's Bend quilts, Margaret's work uses the remnants of corduroy provided by Sears Roebuck for catalog products.



3. Untitled (Horses), Circa 1990
Purvis Young

Young's ubiquitous horses appear on found material – an example of the southern vernaculars use of what was on hand.



4. Mary, 1987, Enamel on board
Joe Light

Joe's almost childlike colors and brushstrokes provide a sense of innocence and lightness.

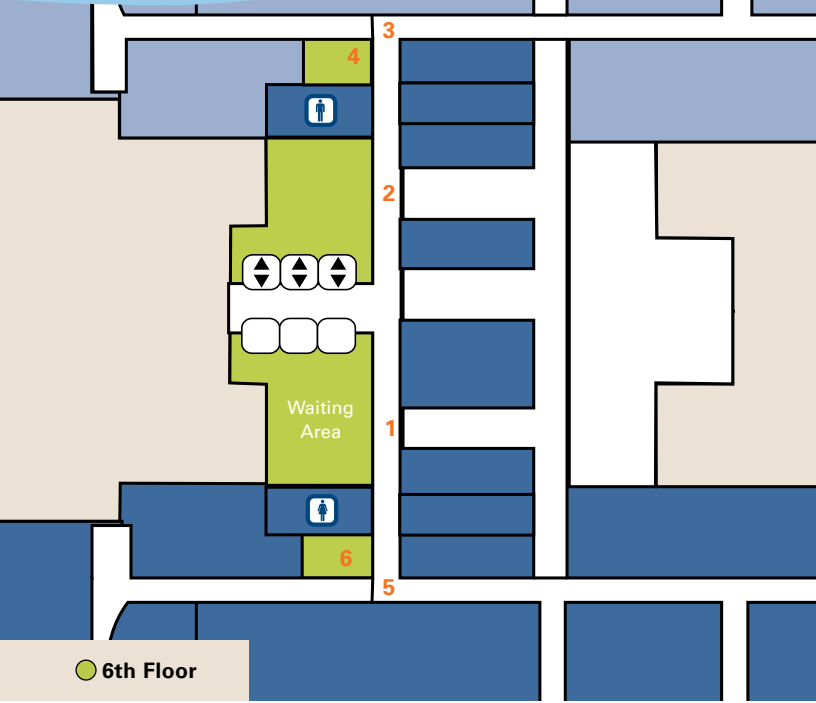

6TH FLOOR

- 1. Still No. 1, Collage
 - 2. Still No. 2, Collage
- Marjorie Guyon, Lexington, Kentucky
 Gift from an anonymous donor



The first thing one notices about Marjorie Guyon’s pieces is the atmosphere they manifest. She creates things of beauty. Through the use of heavily layered pigment and marble dust, she evokes the essence of

landscape of earth and the colors that speak “earth” by their presence. These landscapes portray the ground we came from, live and work on and eventually the place our bodies return to when we die. By referencing the colors of earth, Guyon draws an emotional connection between our creativity and our landscape.

- 3. The mystery does not get any clearer by repeating the question. Photography
 - 4. A decision reached at the crossroads of doubt. Photography
 - 5. Opportunity whispers as often as it knocks. Photography
 - 6. The moment hope becomes faith. Photography
- Keith Auerbach, Louisville, Kentucky

A licensed psychiatrist, Keith’s hobbies include travel and photography. He takes his travel photos of places and manipulates them into pieces of art that obscure their beginnings. His tongue-in-cheek titles reveal his professional tendencies.

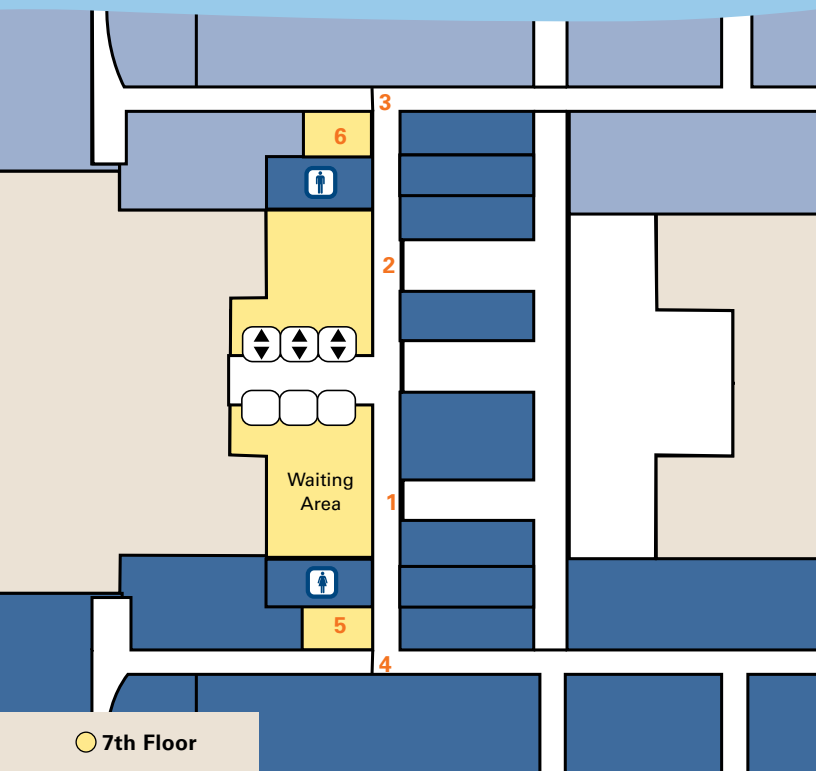

7TH FLOOR

1. Billow, Oil on panel

2. Billow II, Oil on panel

Emil Robinson, Cincinnati, Ohio

Emil's paintings are an attempt to glean spiritual resonance from even the most mundane aspects of life. He believes in the power of painting to communicate something mysterious. There are nameable things in his paintings; however, he is invested in the unnameable as the primary subject.

"A carefully made painting is a perfect answer to the information inundation in contemporary society."

3. Fractal Landscape, 2009, Oil on Canvas

4. Enfolded, 2011, Oil on Canvas

Carolyn Young Hisel, Lexington, Kentucky

Gift from Judy and Byron Young

Carolyn's work address the beauty of the natural world around her...transformed, informed and blessed by light. Her paintings come from the hills, meandering creeks, barns and magnificent trees of central Kentucky. This Place is her inspiration. Her paintings sprang from this fertile soil, but they also are about abstraction, subtraction, rhythmic lines and colors that dance.

5. August Decoy, Watercolor on paper

6. Orange Mambo #2, Watercolor on paper

Lisa Williamson, Tomohawk, Kentucky

These works are part of Lisa's Meadow Series Portfolio which began in 2006 in memory of her father, who loved the hills and woods on his Kentucky farm. Each of her paintings "hold a surface recording, filtered through (her) revolving awareness of the relationship of color and shape via plant life and human life. A dance of relationship."

ADDITIONAL ART INFORMATION

Elevator Lobbies

The patient floors are assigned a color and a photographic image of Kentucky taken by local photographer Lee Thomas. The image is presented as a duotone in the floor color at the elevator lobby and on the patient room signs. This photography helps with wayfinding and floor location.

Additional equine photography by Lee Thomas can be found in the main corridor of Pavilion H.

Workstations

The workstation art is a collection of local and regional artists working in all mediums. The staff was involved in the artist selection based on the needs of patients and families. Three works from each artist are presented "gallery style" so viewers have a broader understanding of their creative voice.

Headwalls

Scenic photographic images of the Kentucky landscape are presented over the patient beds in each room. These images were drawn from the Celebrate Kentucky Wall located on Floor 1.

Performing Arts

A grant from the Lucille Caudill Little Foundation provided the impetus for a performing arts program. The program currently includes recital performances by School of Music students and a Music Therapy program. The UK Music Therapy Program offers the only graduate-level degree in music therapy in the region. Faculty and students also provide clinical support throughout UK HealthCare. With continued funding support, the program will expand performance events and genres. Future plans include transmitting performances to patient rooms throughout the UK Albert B. Chandler Hospital and our partner hospitals across the state.

The UK Arts in HealthCare Program is primarily funded with private monies. If you would like to make a donation to support our continuing efforts to bring the arts to the health care environment, please contact Victoria Myers 859-323-6306.

