

Wetland BMP Manual:

Techniques for Avoidance and Minimization

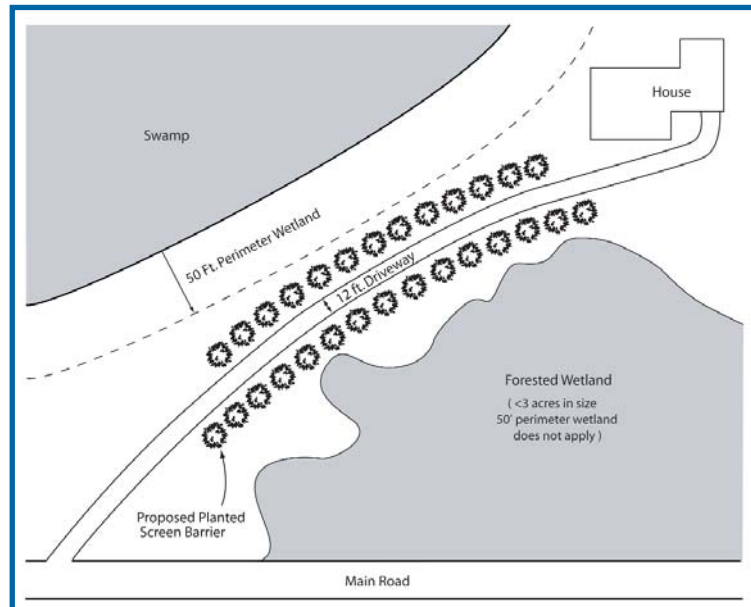

Rhode Island Department of Environmental Management
Office of Water Resources
Freshwater Wetlands Program

April 2010



Dedication

The Wetland BMP Manual: Techniques for Avoidance and Minimization

is dedicated to the memory of

Carl A. Ruggieri (1963 - 2006)

in honor of his fifteen years of dedicated service to the

Rhode Island Department of Environmental Management Freshwater Wetlands Program.

Table of Contents

Dedication	ii
List of Examples	iv
Introduction	vi
1. The Importance of Protecting Wetlands	1-1
2. Single-Family Lots	2-1
3. Subdivisions	3-1
4. Commercial and Industrial Projects	4-1
5. Golf Courses	5-1
6. Bike Paths, Foot Paths, Trails and Boardwalks	6-1
7. Roads and Bridges	7-1
8. Utilities	8-1
9. Wetland Crossings	9-1
10. Plantings	10-1
11. Construction and Maintenance Tips	11-1
12. References & Resources	12-1
Acknowledgements	

List of Examples

Chapter		Page
2. Single-Family Lots		
1a	Original Plan for a Single-Family Home	2-2
1b	Revised Plan for a Single-Family Home with Avoidance and Minimization	2-3
2a	House Placement Original Design	2-4
2b	House Placement Revised Design	2-5
3a	Lot Layout Original Design	2-6
3b	Lot Layout Revised Design	2-7
4	Marking the Buffer Zone	2-8
3. Subdivisions		
5a	Original Subdivision Plan	3-2
5b	Revised Subdivision Plan with Avoidance and Minimization (Option 1)	3-3
5c	Revised Subdivision Plan with Avoidance and Minimization (Option 2)	3-4
6a	Subdivision Layout Original Design	3-5
6b	Subdivision Layout Revised Design	3-6
4. Commercial and Industrial Projects		
7a	Storage Facility Original Design	4-3
7b	Storage Facility Revised Design	4-4
8	Lighting	4-5
9	Retaining Wall	4-6
5. Golf Courses		
10	Avoiding a Large Wetland Complex	5-3
11a	Original Design for Emergent Plant Community Crossing	5-4
11b	Revised Design for Emergent Plant Community Crossing	5-5
12a	Original Design with Multiple Wetlands	5-6
12b	Revised Design with Multiple Wetlands	5-7
13	Crossings	5-8
14	Cart Paths	5-9
15	Preserved Areas	5-10
6. Bike Paths, Foot Paths, Trails and Boardwalks		
16	Path Layout and Design	6-4
17	Path Width and Buffers	6-5
18	Vegetative Clearing	6-5
19	Wetland Crossings	6-6
20a	View Corridor and Access Areas	6-7
20b	Revised Design A	6-7
20c	Revised Design B	6-8

List of Examples, Continued

Chapter	Page
6. Bike Paths, Foot Paths, Trails and Boardwalks, Continued	
21a Original Planting Design	6-9
21b Revised Planting Design	6-10
7. Roads and Bridges	
22 Typical Slope Treatments	7-2
23 Special Slope Treatments	7-4
24 Bridge Upgrade	7-5
8. Utilities	
25 Enlarged Pipeline Avoidance and Minimization	8-4
26 Above-Ground Installation	8-5
27 Trenching	8-7
28 Horizontal Directional Drilling	8-8
9. Wetland Crossings	
29 Crossing Structures	9-2
30 Detailed Labeling Required for Crossings	9-3
31 Piped Culvert Crossing	9-4
32 Open-Bottom Box Culvert Crossing	9-5
33 Timber Bridge Crossing	9-6
34 Concrete Arch Crossing	9-7
35 Multi-Span Bridge Crossing	9-8
36a Wildlife Crossings - Modified Box Culvert	9-9
36b Wildlife Crossings - Polyethylene Arch	9-10
10. Plantings	
37 Planting Methods	10-5
38 Planting Schedule	10-6
39 Mixed Plantings	10-7
40 Tree and Shrub Installation	10-8
11. Construction and Maintenance	
41 Construction Sequencing Stages	11-6
42 Erosion Checks - Baled Hay and Silt Fence	11-9