

REPORT OF GENERAL MANAGER

NO. 16-004

DATE January 06, 2016

C.D. 4

BOARD OF RECREATION AND PARK COMMISSIONERS

SUBJECT: GRIFFITH PARK – AUTRY MUSEUM OF THE AMERICAN WEST – OUTDOOR SCULPTURE INSTALLATION

\*R. Barajas anf K. Regan \_\_\_\_\_  
H. Fujita \_\_\_\_\_ N. Williams \_\_\_\_\_  
V. Israel \_\_\_\_\_

Roman Barajas for  
General Manager

Approved ✓ Disapproved \_\_\_\_\_ Withdrawn \_\_\_\_\_  
As Amended

RECOMMENDATIONS:

That the Board:

1. Grant approval for the Autry Museum of the American West to install on their leased land a 1999 cast bronze sculpture, entitled Intertribal Greeting, by artist Doug Hyde; and,
2. Authorize staff to issue a Right-of-Entry (ROE) permit to the Autry Museum of the American West and their contractor(s) to perform all work related to the installation and landscaping of the project.

SUMMARY:

Griffith Park is a regional park of over 4,000 acres, bounded by Los Feliz Boulevard, the 134 Freeway and the 5 Freeway. Griffith Park has many unique features including golf courses, the Greek Theatre, the Griffith Observatory, pony rides, the Travel Town Museum and the Autry Museum of the American West. Griffith Park is a regional resource and a destination for residents of the City of Los Angeles and beyond.

In July 2015, the Department of Recreation and Parks (RAP) was contacted by the Autry Museum of the American West (Autry) with a request to install a sculpture within the existing Autry leasehold area. Autry proposes to place the sculpture on the exterior of the Museum in an unpaved portion of the grounds adjacent to the public walkway (Exhibit A). The statue is titled *Intertribal Greeting* and is represents several American Indian communities. *Intertribal Greeting* is a cast bronze sculpture that depicts five (5) women, each representing a unique American Indian community – some of whose art, history, and voices are presented in the museum’s galleries. The intention of installing *Intertribal Greeting* at one of the entrances to the Autry museum complex is to welcome visitors to the museum in a meaningful and beautiful way. An image of the statue is attached to this Report as Exhibit B.

## REPORT OF GENERAL MANAGER

PG. 2

NO. 16-004

The sculpture entitled "Intertribal Greeting" was created by a Native artist Doug Hyde in 1999. This outdoor sculpture is part of a collection of art that was gifted to the Autry and is featured in a new museum exhibition, *New Acquisitions Featuring the Kaufman Collection*, currently on display.

Born in Hermiston, Oregon in 1946, award-winning artist Doug Hyde – whose heritage includes Nez Perce, Assiniboine, and Chippewa – was inspired by the lore he learned as a youth from the tribal elders. In the early 1960s, Hyde traveled to Santa Fe, New Mexico to attend the Institute of American Indian Arts (IAIA). After two (2) tours in Vietnam, he returned to IAIA where he began his devotion to art as part of the school's faculty from 1972 to 1974.

Mr. Hyde expresses Indian mythology and spirit through his sculpture. Hyde's work is included in museum collections nationwide including the Smithsonian Institution in Washington, DC, the Amon Carter Museum of Western Art in Fort Worth, Texas, the Heard Museum in Phoenix, Arizona, the Institute of American Indian Arts in Santa Fe, New Mexico, the Gilcrease Museum in Tulsa, Oklahoma, Lewis and Clark State College in Lewiston, Idaho and the City of Palm Springs, California.

The Autry is proposing to place the sculpture by the museum entrance. A detail of the proposal and the associated native plantings is attached to this Report as Exhibit C. A small, museum quality, expository plaque detailing the artist, date and sculpture specifics will be included in the installation. ~~The Facility Repair and Maintenance Commission Task Force reviewed this proposal at its regularly scheduled meeting on December 9, 2015.~~ The Facility Repair and Maintenance Commission Task Force reviewed this proposal at its regularly scheduled meeting on December 9, 2015 and recommended that the proposal be forwarded to the full Commission for review. This proposal was presented to the Griffith Park Advisory Board on December 10, 2015. There were approximately fifty (50) persons in attendance at the meeting. The Park Advisory Board voted unanimously in support of the proposal.

### ENVIRONMENTAL IMPACT STATEMENT:

Staff has determined that the subject project is exempt from the provisions of the California Environmental Quality Act (CEQA), pursuant to Article III, Section 1, Class 11 (6), of the City CEQA Guidelines.

Management and staff support this project at the Autry Museum of the American West within Griffith Park.

### FISCAL IMPACT STATEMENT:

There shall be no cost to RAP as the costs of installation, maintenance, and removal shall be the sole responsibility of the Autry Museum of the American West.

This Report was prepared by Deirdre Symons, Senior Clerk, Griffith Region and Melinda Gejer, City Planning Associate, Planning, Construction and Maintenance Branch.

**Exhibit A**  
**Proposed Sculpture Location**

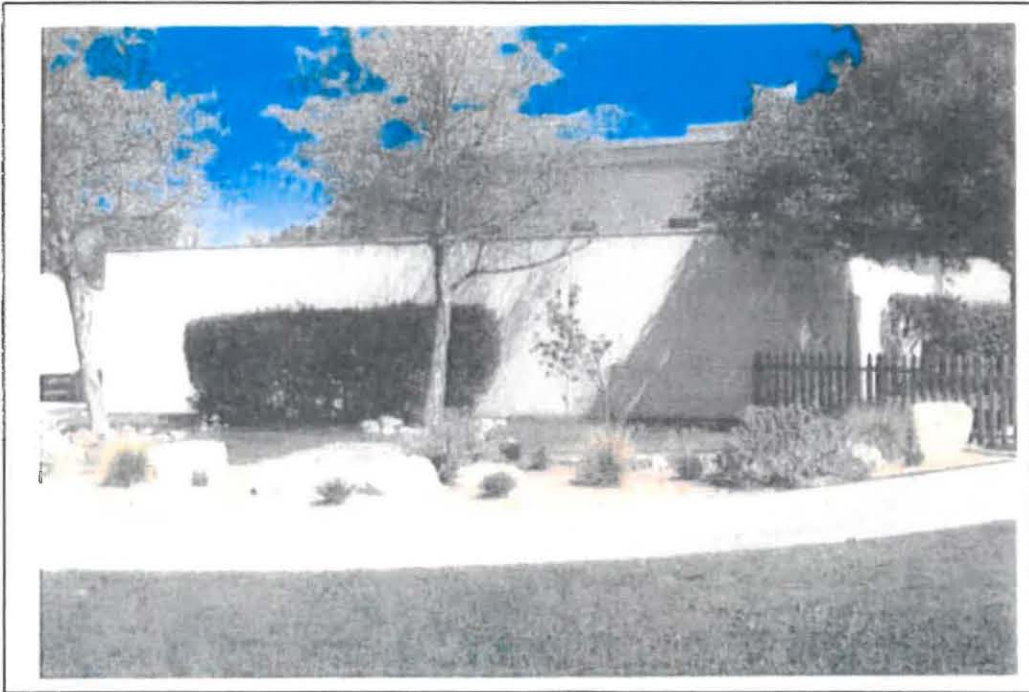

**Exhibit B**  
**Proposed Sculpture**

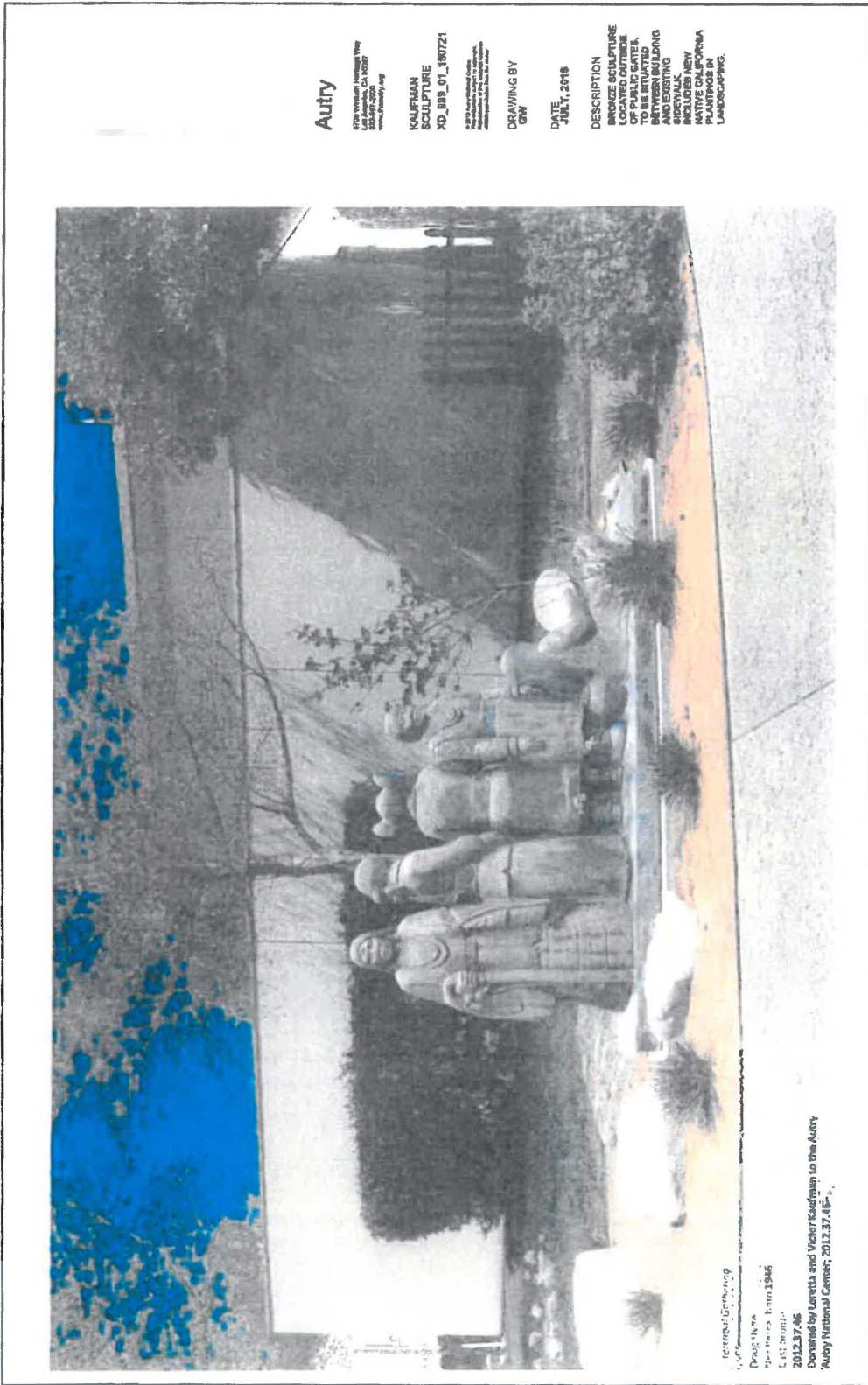

**Autry**

©2013 Victor Kauffman  
Los Angeles, CA 90028  
www.victorkauffman.com

**KAUFFMAN  
SCULPTURE  
NO\_BB\_01\_180721**

©2013 Victor Kauffman  
Los Angeles, CA 90028  
www.victorkauffman.com

**DRAWING BY  
GM**

**DATE  
JULY, 2013**

**DESCRIPTION  
BRONZE SCULPTURE  
TO BE SITUATED  
BETWEEN BUILDING  
AND EXISTING  
LANDSCAPING.  
INCLUDES VERY  
NATIVE CALIFORNIA  
PLANTINGS IN  
LANDSCAPING.**

Victor Kauffman  
Los Angeles, CA 90028

Project Name: Autry 1946

Artist: Victor Kauffman

2013.37.46

Donated by Loretta and Victor Kauffman to the Autry  
Autry National Center, 2013.37.46

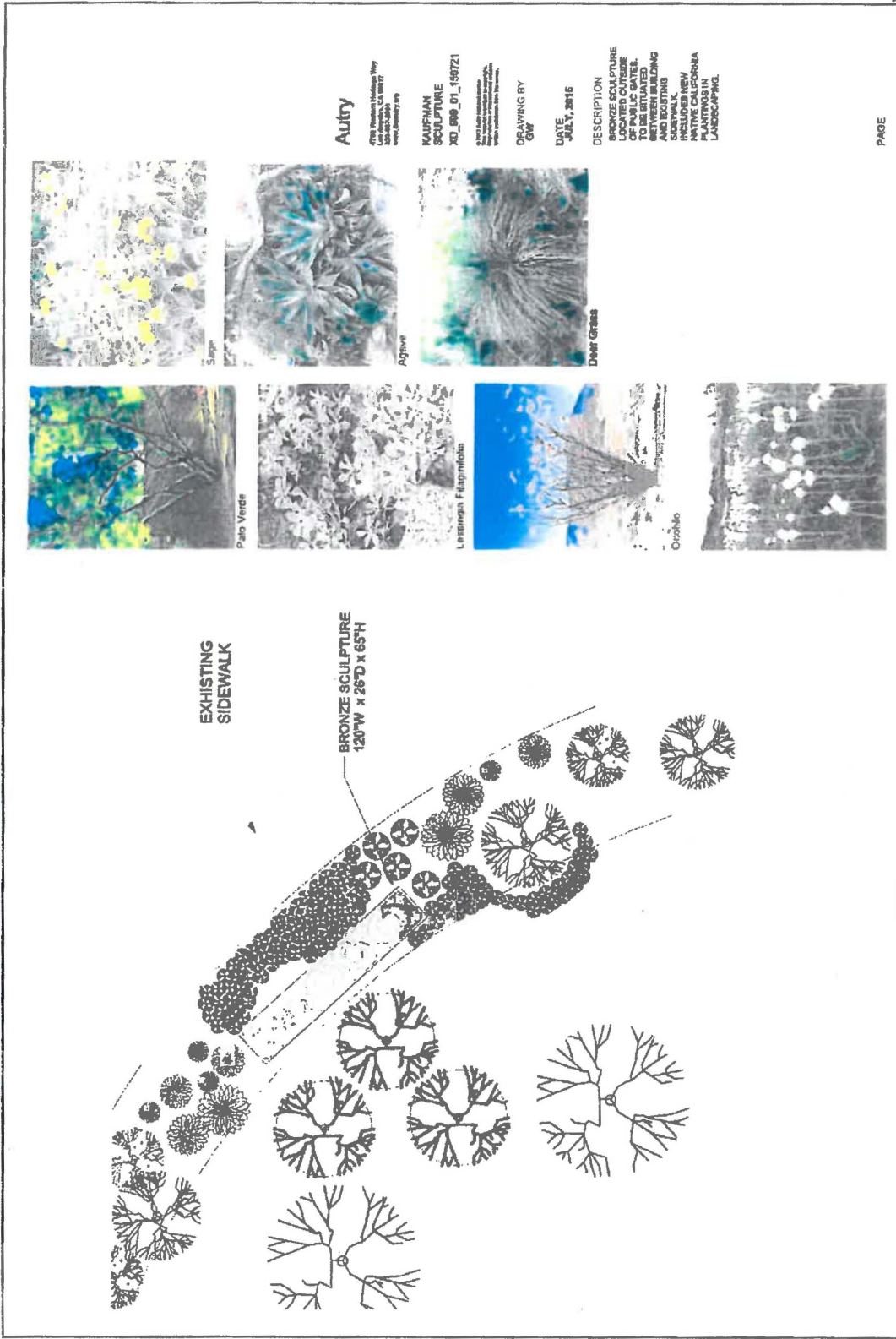

**Autry**

4745 Piedmont Lakeside Way  
San Jose, CA 95121  
www.autry.com

**KAUFMAN  
SCULPTURE  
XD\_000\_01\_190721**

1000 Lakeside Blvd  
San Jose, CA 95128  
www.kaufman.com

**DRAWING BY  
GFF**

**DATE  
JULY, 2016**

**DESCRIPTION**  
THE SCULPTURE  
LOCATED OUTSIDE  
OF PUBLIC GATES.  
TO BE SITUATED  
WITHIN THE EXISTING  
AND EXISTING  
SIDEWALK.  
INCLUDES NEW  
PLANTINGS AND  
LANDSCAPING.

PAGE