

APPROVED
06-15-2016

BOARD OF RECREATION
AND PARK COMMISSIONERS

BOARD REPORT

NO. 16-144

DATE June 15, 2016

C.D. 14

BOARD OF RECREATION AND PARK COMMISSIONERS

SUBJECT: ROSE HILL PARK – NEW PEDESTRIAN PATHWAYS AND WALKWAYS
(A.K.A. AMERICANS WITH DISABILITIES ACT WALKING PATH) (PRJ20930)
(W.O. #E170383F) PROJECT – FINAL ACCEPTANCE

AP Diaz	_____	V. Israel	_____
<i>for</i> *R. Barajas	<u>CSD</u>	K. Regan	_____
H. Fujita	_____	N. Williams	_____

Ramon Barajas for
General Manager

Approved ✓ Disapproved _____ Withdrawn _____

RECOMMENDATIONS

1. Accept the work performed for the Rose Hill Park - New Pedestrian Pathways and Walkways, also known as Americans with Disabilities Act (ADA) Walking Path, (PRJ20930) (W.O. #E170383F) project (Project), constructed by the Department of Recreation and Parks (RAP) as-needed pre-qualified on-call vendors, as outlined in the Summary of this Report; and,
2. Authorize the Board Secretary to furnish the contractors with a Letter of Completion for the Project.

SUMMARY

The Rose Hill Park – New Pedestrian Pathways and Walkways (a.k.a. Americans with Disabilities Act Walking Path) (PRJ20930) (W.O. #E170383F) project (Project) is in Council District 14, and is located at 3606 North Boundary Avenue, Los Angeles, California 90032. The scope of work included extending the existing ADA compliant walkways between Rose Hill Park’s restrooms and baseball fields. Two five-foot wide ADA compliant concrete walkways were built. The first walkway is approximately three hundred ten (310) feet in length. The second walkway is approximately four hundred fifty (450) feet long. As required by ADA guidelines, both of these walkways have a maximum of 5 percent (5%) slope in the direction of travel, and no more than two percent (2%) cross slope. Plans for the Project were prepared by the Department of Public Works, Bureau of Engineering (BOE), Architectural Division. The Board approved the use of pre-qualified on-call vendors on May 6, 2015 (Report No. 15-097). On September 22, 2015, a Notice To Proceed, in the amount of Two Hundred Sixty-Eight Thousand Dollars (\$268,000.00), was issued to Evergreen Environmental, Inc.

BOARD REPORT

PG 2 NO. 16-144

During the course of construction, a total of four Change Orders were issued for the Project, in the amount of Nine Thousand, Six Hundred Fourteen (\$9,614.00), or 3.6% of the base award amount. One change order was attributed to unforeseen conditions (0.5%), and three change orders were attributed to errors and omissions (3.1%).

Vendor	Original Award Amount	Change Order Amount	Total Amount
Evergreen Environment, Inc.	\$268,000.00	\$9,614.00	\$277,614.00

TREES AND SHADE

Trees and shade were not part of the scope of work as defined by the funding of this Project. The existing trees were not affected by the construction of this Project.

The BOE Program Manager has reviewed the as-built plans and concurs that Project has been completed in accordance with the plans and specifications. There were no contract compliance or labor issues with the completed work.

FISCAL IMPACT STATEMENT

There is no fiscal impact to RAP. RAP currently operates the facility and operating budgets are in place.

This Report was prepared by Erick Chang, Project Manager, Recreational and Cultural Facilities Division, Bureau of Engineering (BOE). Reviewed by Neil Drucker, Program Manager, Recreational and Cultural Facilities Division, BOE; Deborah Weintraub, Chief Deputy City Engineer, BOE; and Cathie Santo Domingo, Superintendent, Planning, Construction and Maintenance Branch.

LIST OF ATTACHMENTS

- 1) Change Order Log
- 2) Change Order Modifications As-Built Plan

ATTACHMENT 1

DEPARTMENT OF PUBLIC WORKS/BUREAU OF ENGINEERING
RECREATIONAL AND CULTURAL FACILITIES DIVISION

Rose Hill Park ADA Walking Path (W.O # E170383F)
Change Order Log

NO	SCOPE OF OF WORK	CHANGE ORDER AMOUNT	TYPE
1	Existing Road elevation and Gutter	\$ 4,000.00	Error and Omission
2	Re-painting existing curbs	\$ 2,500.00	Error and Omission
3	Drinking fountains additional concrete	\$ 1,895.00	Error and Omission
4	Soil Over Excavation & CMB base	\$ 1,219.00	Unforeseen Conditions
	<i>Total:</i>	\$ 9,614.00	

SUMMARY BY TYPE	AMOUNT	Percentage
Unforeseen Conditions	\$1,219.00	0.5%
Error and Omission	\$8,395.00	3.1%
Total Amount:	\$9,614.00	3.6%

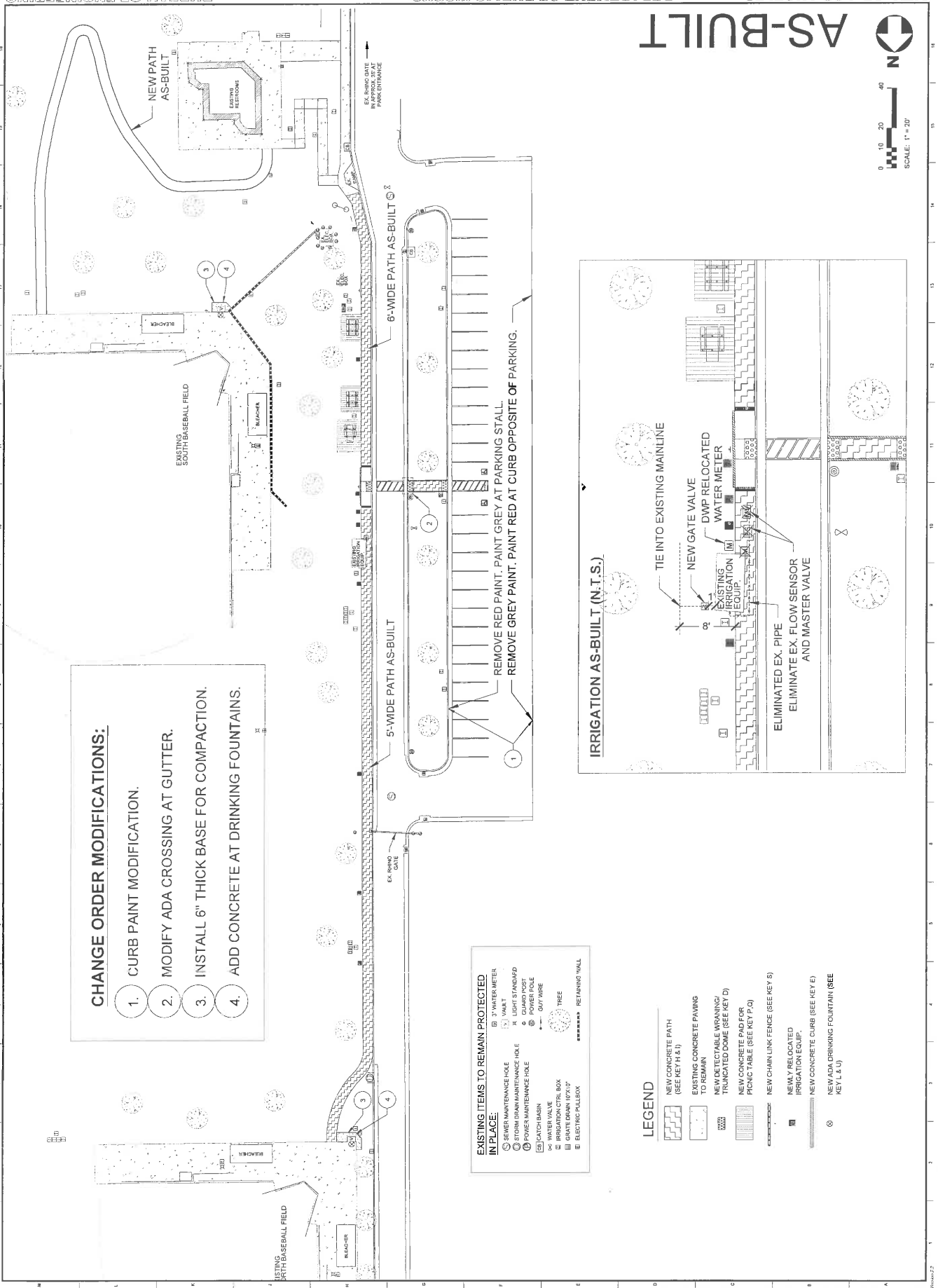

CHANGE ORDER MODIFICATIONS:

1. CURB PAINT MODIFICATION.
2. MODIFY ADA CROSSING AT GUTTER.
3. INSTALL 6" THICK BASE FOR COMPACTION.
4. ADD CONCRETE AT DRINKING FOUNTAINS.

- EXISTING ITEMS TO REMAIN PROTECTED IN PLACE:**
- ⊗ 3" WATER METER
 - ⊗ SEWER MAINTENANCE HOLE
 - ⊗ STORM DRAIN MAINTENANCE HOLE
 - ⊗ POWER MAINTENANCE HOLE
 - ⊗ CATCH BASIN
 - ⊗ WATER VALVE
 - ⊗ IRRIGATION CTRL. BOX
 - ⊗ GRATE DRAIN 10"x10"
 - ⊗ ELECTRIC PULLBOX
 - ⊗ VENT
 - ⊗ LIGHT STANDARD
 - ⊗ GUARD POST
 - ⊗ GUARD RAIL
 - ⊗ GUY WIRE
 - ⊗ TREE
 - ⊗ RETAINING WALL

- LEGEND**
- ▭ NEW CONCRETE PATH (SEE KEY H & I)
 - ▭ EXISTING CONCRETE PAVING TO REMAIN
 - ▭ NEW DETECTABLE WRANING/ TRUNCATED DOME (SEE KEY D)
 - ▭ NEW CONCRETE PAD FOR PICNIC TABLE (SEE KEY P, Q)
 - ▭ NEW CHAIN LINK FENCE (SEE KEY S)
 - ▭ NEWLY RELOCATED IRRIGATION EQUIP.
 - ▭ NEW CONCRETE CURB (SEE KEY E)
 - ⊗ NEW ADA DRINKING FOUNTAIN (SEE KEY L & U)

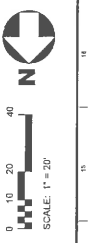

AS-BUILT

CITY OF LOS ANGELES DEPARTMENT OF PUBLIC WORKS BUREAU OF ENGINEERING

