

NOTES
 1. REFER TO SPECIFICATIONS FOR MODEL UNITS, COORDINATE LOCATION OF MODEL UNITS WITH ARCHITECT & OWNER DURING CONSTRUCTION.

VETERANS' HOME - VETERANS' LAND BOARD OF THE STATE OF TEXAS

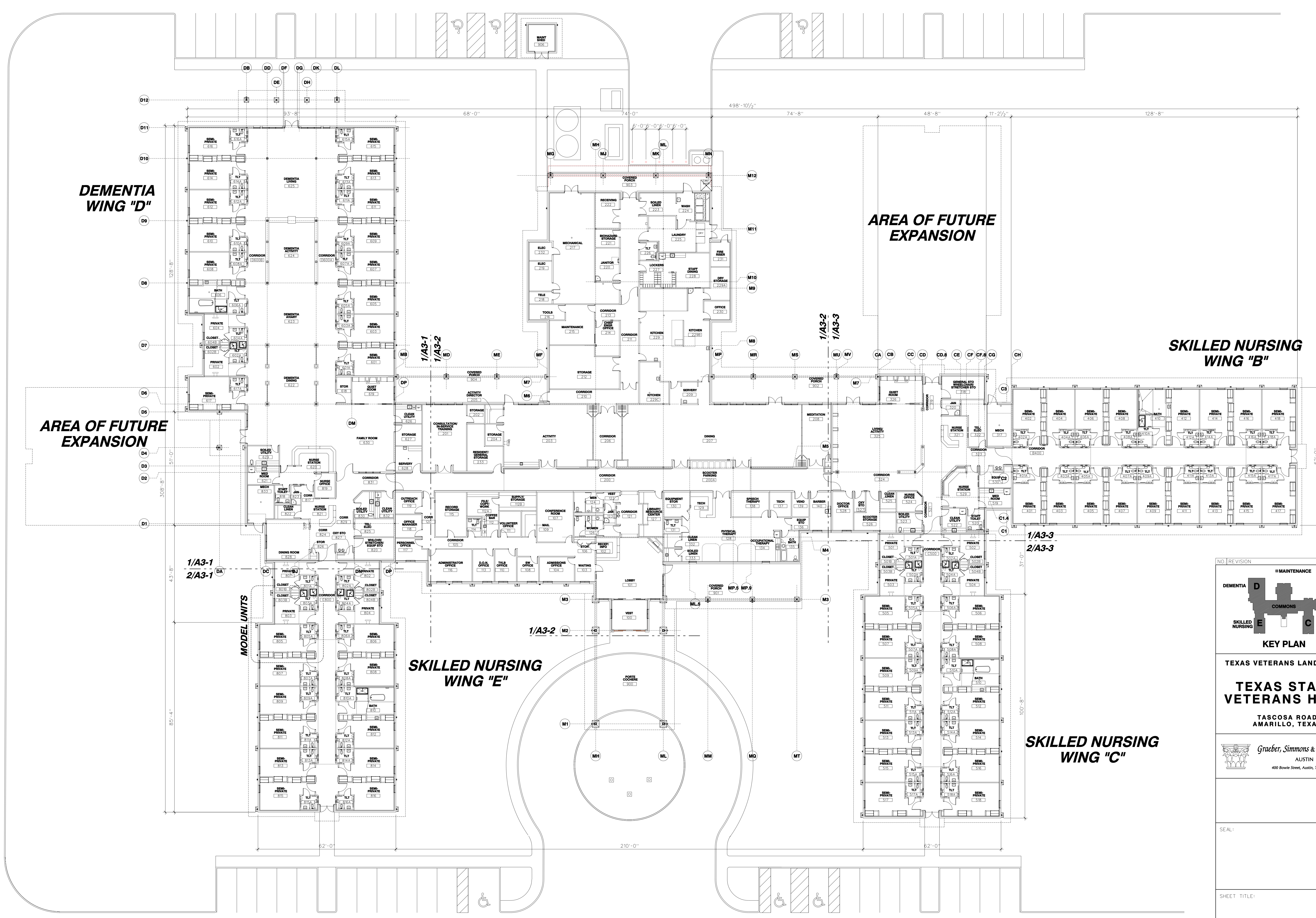

DEMENTIA WING "D"

AREA OF FUTURE EXPANSION

SKILLED NURSING WING "B"

AREA OF FUTURE EXPANSION

SKILLED NURSING WING "E"

SKILLED NURSING WING "C"

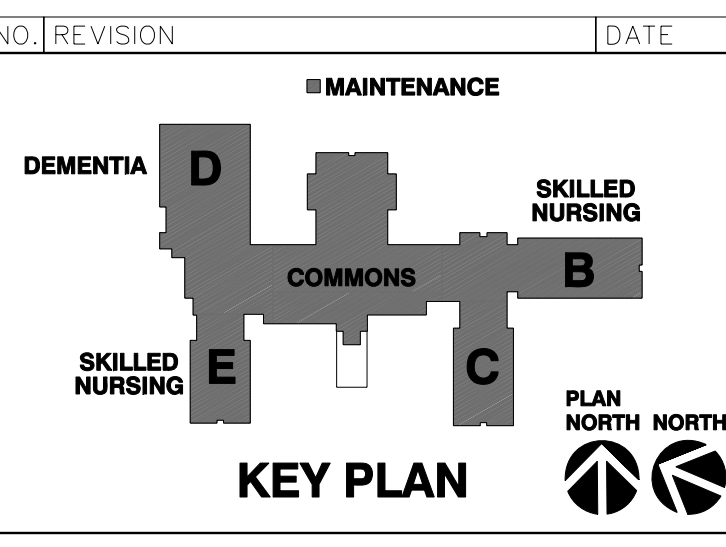

TEXAS VETERANS LAND BOARD
TEXAS STATE VETERANS HOME
 TASCOSA ROAD
 AMARILLO, TEXAS

Graber, Simmons & Cowan, Inc.
 AUSTIN
 400 Bowie Street, Austin, Texas 78703

NO. REVISION	DATE
SEAL:	
SHEET TITLE:	OVERALL FLOOR PLAN
DATE: 1/5/2005	PRJ. NO.: 200402300
DRAWN BY:	SHEET NO.:
CHECKED BY: EPR	A3-0
SCALE: 1/16" = 1'-0"	

02/08/2007
 02:52:59 PM
 m:\prj\200402300\vrch\SH\T\lva0300.dgn

CONSTRUCTION DOCUMENTS 1/5/2005