

**Donovan Hall, Lyman T. Johnson Hall,  
Haggin Hall\*, Smith, Baldwin and Ingels**

**4 Person Suite**



*All measurements L x W x H*

**Kitchen Area**

Dining Table: Height: 3'7" Diameter: 2'6"

Bar Stool: 1'4" x 1'3" x 2'7"

Microwave-Refrigerator: 1'6" x 1'6" x 3'4"

Microwave: 1'6 x 1'0" x 9"

Freezer: 1'6" x 1'6" x 9"

Refrigerator: 1'6" x 1'6" x 1'8"

Kitchen Counter: 7'9" x 1'4" x 6"

Kitchen Sink: 1'9" x 1'4" x 6"

Cabinets (x2): 10" x 1'6" x 4.5"

Cabinets (x2): 10" x 1'10" x 2'0"

Cabinets (x2): 2'7" x 2'0" x 1'10"

Cabinet: 2'10" x 2'0" x 2'4"

**Bathroom**

Sink Counter Top: 4'11" x 2'0" x 2'9"

Sink: 1'9" x 1'4" x 6"

Cabinet (x4): 10" x 1'6" x 5"

Cabinet (x2): 2'4" x 2'0" x 1'8"

Toilet: 2'6" x 1'2" x 2'5"

Shower (from Shower Rod): 3'10" x 2'10" x 6'6"

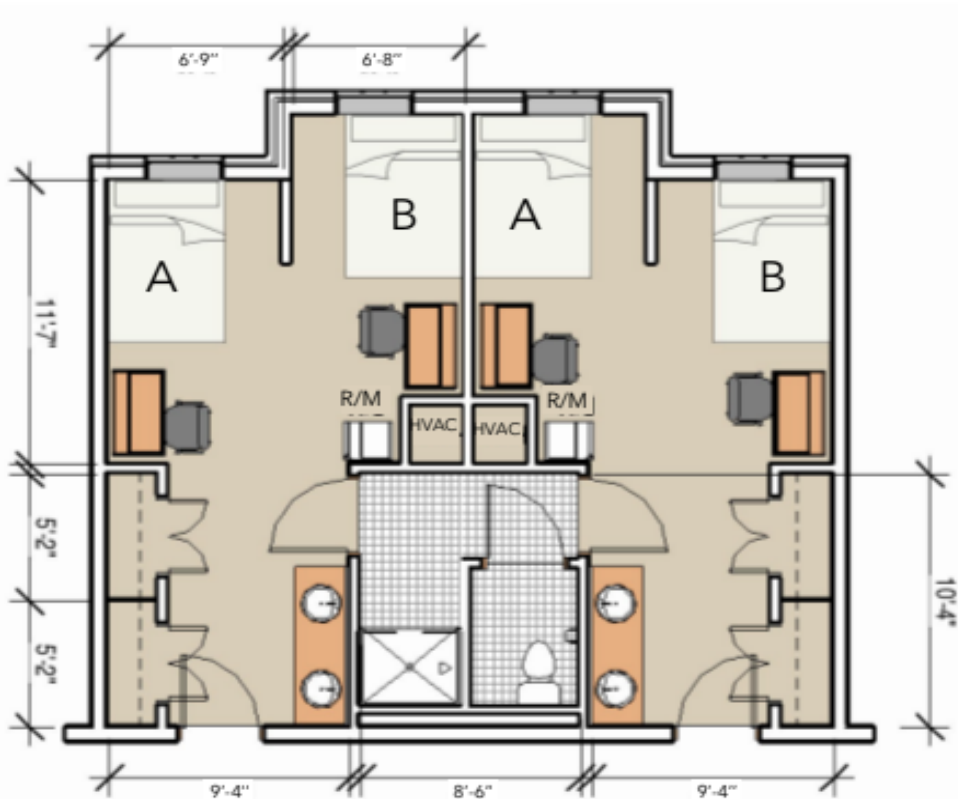

**Bedroom**

Closet Shelf: 5'0" x 2'0"

Ceiling to Closet Shelf: 4'0"

Closet Shelf to Floor: 5'0"

Desk: 3'6" x 1'10" x 2'6"

Bed Frame: 7'0" x 3'16" x 1'10"

\*Haggin Hall is a Full XL Bed Frame: 7'0" x 4'8" x 1'10"

Dresser (x2): 2'8" x 1'6" x 1'8" (stackable)

Window: 5'0" x 5'5" Length to floor: 7'8"

**All the windows are not the same size.**