

An aerial photograph of a university campus, showing a grid of buildings, streets, and green spaces. The image is overlaid with a semi-transparent blue filter. The text is positioned in the upper right quadrant of the image.

# THE UNIVERSITY OF KENTUCKY

LANDSCAPE STUDY

FEBRUARY 13, 2014



# LANDSCAPE STUDY SITES



1. Avenue of Champions from Limestone to Woodland
2. Rose Street from Euclid Avenue to S. Limestone Street
3. Woodland Avenue and Hilltop Avenue (segments proposed for closure)
4. Funkhouser to Memorial Coliseum
5. Memorial Hall to Martin Luther King Boulevard
6. Memorial Hall to WT Young Library, including the front lawn and amphitheater at Memorial Hall
7. Taylor Education to Maxwell Place
8. From Central Halls and the proposed Science Building to the Funkhouser / Memorial Coliseum corridor

9. Paths connecting the College of Agriculture to the campus core
10. Pennsylvania Court (pedestrian walk leading into the Greek District)
11. Main Building Lawn
12. The Botanical Garden between Patterson Office Tower and the Student Center
13. The White Hall Classroom Building Quad
14. Library Drive, behind the Chemistry-Physics Building
15. The area south of Alumni Drive near the Arboretum
16. Washington Street (not in scope: additional study)
17. Kirwan-Blanding (not in scope: additional study)



# EXISTING PLAN



▲ EXISTING ILLUSTRATIVE PLAN



# PROPOSED PLAN



▲ PROPOSED ILLUSTRATIVE PLAN



# PROPOSED OPEN SPACE FRAMEWORK



▲ PROPOSED OPEN SPACE FRAMEWORK

- CIVIC SPACE
- QUADRANGLE AND COURTYARD
- STREETSCAPE
- PEDESTRIAN CORRIDOR
- SPORTS LANDSCAPE
- NATURAL AREA AND PARK
- PLAZA
- PARKING AND SERVICE ROAD



# SUSTAINABILITY

## CAMPUS ZONES

Total UK Ownership 811 Acres

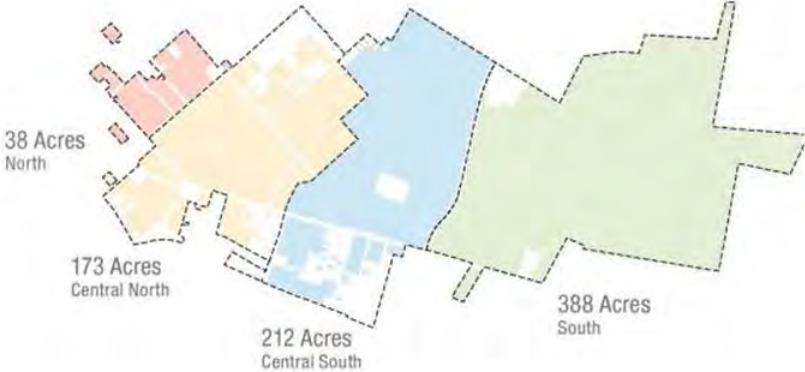

## PROPOSED BUILDING COVERAGE

Total Proposed UK Building Coverage 21% 174 Acres



## PROPOSED IMPERVIOUS SURFACES

Total Proposed UK Building Coverage 21% 174 Acres



## PROPOSED TREE COVERAGE

Total Proposed UK Tree Coverage 19% 143 Acres





# SUSTAINABILITY



## Landscape and Ecology

A goal of the master plan is to create enduring campus places that improve outdoor comfort and contribute to campus ecology. The following strategies were integrated in the master plan, and will be further explored in the related landscape master plan:

- Identification of areas for additional tree planting for wind protection and shade to improve outdoor comfort
- Reduction of hard surface areas to mitigate heat island effects
- An overall increase in pervious surface areas to improve ground water recharge and stormwater management
- Creation of a new stormwater detention basin within the South Campus to manage stormwater within this area of the campus
- The integration of elements such as parking gardens, bio-swales and filter strips to capture and filter rainwater
- Protection and enhancement of habitats and natural systems, with enhanced connections to broader regional systems



## Mobility

A goal of the master plan is to create a comprehensive system of pedestrian, bicycle, transit and vehicular movement to reduce the need for single-occupancy vehicle trips, and improve overall accessibility across the campus. The master plan creates a more compact campus to facilitate improved pedestrian, bicycle and transit connectivity. It also prioritizes pedestrian movement within the campus core, aligns bicycle routes with bicycle parking facilities, and creates a transit hub with more efficient routes to encourage transit use. The master plan coordinates campus mobility strategies with surrounding city and regional transportation plans and policies.





MAXWELL STREET

EUCLID AVENUE

AVENUE OF CHAMPIONS

ROSE STREET

SOUTH LIMESTONE

HUGOBLETTE

11

2

4

6

14

7

16

3

17

1

15

18

8

20

10

19

9

13

12

5





COLUMBIA AVENUE

WOODLAND AVENUE

ROSE STREET

HILLTOP AVENUE

UNIVERSITY DRIVE

HUGUELET DRIVE

COMPLEX DRIVE

2

2

2

2

2

3

2

1

3

5

6

4

3

1





EUCLID AVE

WOODLAND AVENUE

ROSE LANE

COLUMBIA AVENUE

ROSE STREET

10

7

9

6

4

6

2

5

6

9

8

5

5

5

3

1

5

5

5

5

5

5

5

5

5

5

5

5

5

5

5

5

5

5

5

5

5

5

5

5

5

5

5

5

5

5

5

5

5

5

5

5

5

5

5

5

5

5

5

5

5

5

5

5

5

5

5

5

5

5

5

5

5

5

5

5

5

5

5

5

5

5

5

5

5

5

5

5

5

5

5

5

5

5

5

5

5

5

5

5

5

5

5

5

5

5

5

5

5

5

5

5

5

5

5

5

5

5

5

5

5



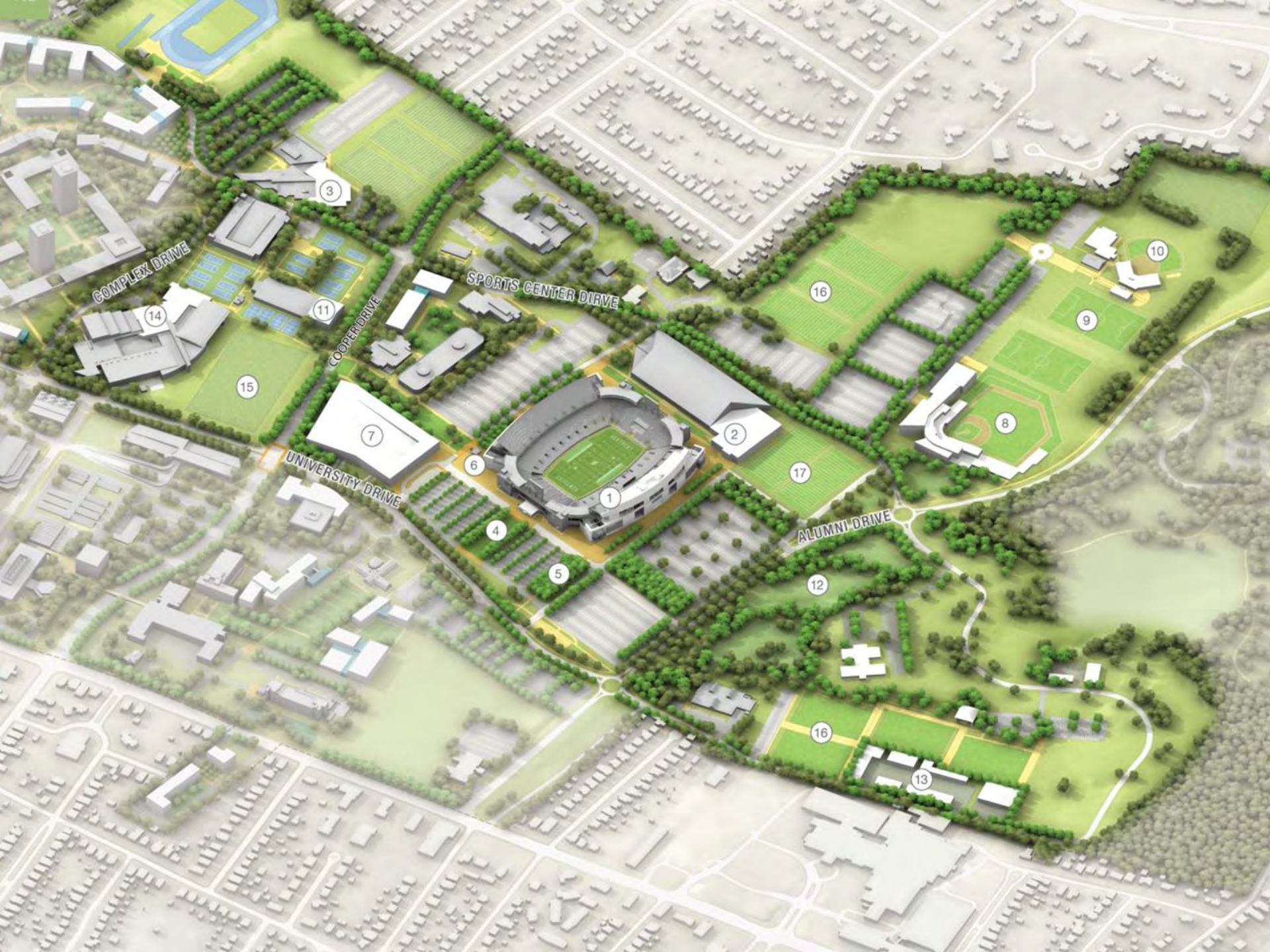

COMPLEX DRIVE

SPORTS CENTER DRIVE

COOPER DRIVE

UNIVERSITY DRIVE

ALUMNI DRIVE

3

14

11

15

7

6

4

5

1

2

17

12

16

13

8

9

10





# OBSERVATIONS

Campus Landscape & Open Space



































An aerial photograph of a city street grid, overlaid with a semi-transparent blue filter. The image shows a dense network of streets and buildings, with a prominent road running diagonally from the top left towards the bottom right. The text 'SITE 1.1:' is positioned in the lower right quadrant of the image.

# **SITE 1.1:**

**Avenue of Champions : : Limestone to Rose**



# SITE 1.1 : AVENUE OF CHAMPIONS





# SITE 1.1 : AVENUE OF CHAMPIONS (LIMESTONE TO ROSE)

## Proposed Concept

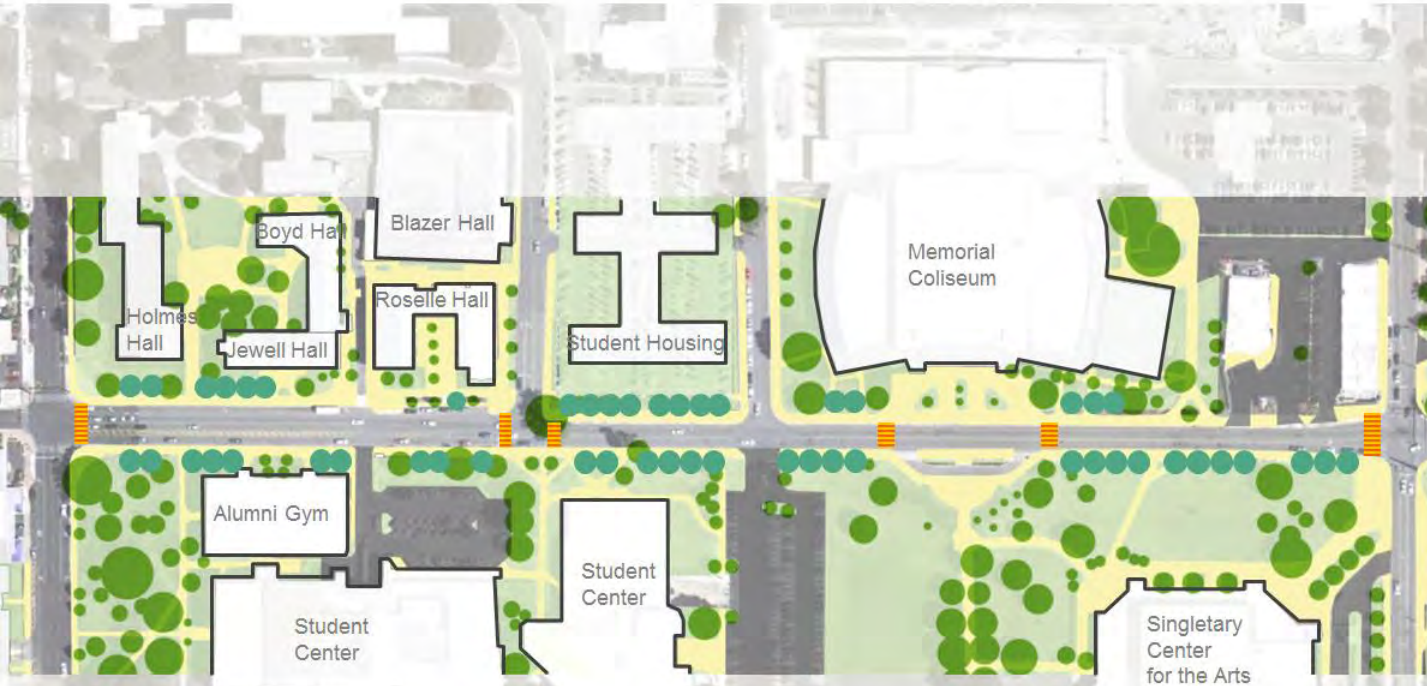

### Objectives:

**Create a unified and memorable pedestrian and open space experience**

1. Improve consistency of the streetscape by adding street trees
2. Provide safe pedestrian crosswalks
3. Preserve existing canopy trees
4. Preserve Memorial Coliseum's plaza



# SITE 1.1 : AVENUE OF CHAMPIONS ( LIMESTONE TO ROSE )

Proposed Concept



AVENUE OF CHAMPIONS ( LIMESTONE TO ROSE )



An aerial photograph of a city street grid, overlaid with a semi-transparent blue filter. The image shows a dense network of streets and buildings, with a prominent road running diagonally from the top left towards the bottom right. The text 'SITE 1.2:' is positioned in the lower right quadrant of the image.

# **SITE 1.2:**

**Avenue of Champions : : Rose to Woodland**



# STREET SECTION A: EUCLID AVE NEAR ROSE STREET





# SITE 1.2 : AVENUE OF CHAMPIONS (ROSE TO WOODLAND)

## Proposed Concept



### Objectives:

**Create a complimentary streetscape continuing the pedestrian experience from Avenue of Champions to Euclid Avenue**

1. Improve consistency of the streetscape by adding street trees along the southern edge of Euclid Avenue
2. Preserve existing canopy trees
3. Improve pedestrian crosswalks



# SITE 1.2 : AVENUE OF CHAMPIONS (ROSE TO WOODLAND)

Proposed Concept



AVENUE OF CHAMPIONS (ROSE TO WOODLAND)



An aerial photograph of a city street grid, overlaid with a semi-transparent blue filter. The streets are arranged in a regular pattern, with buildings and trees visible between them. The overall tone is a muted blue.

# **SITE 2.1:**

**Rose Street : : Euclid Ave. to Columbia Ave.**



# SITE 2.1: ROSE STREET





# SITE 2.1 : ROSE STREET (EUCLID AVE. TO COLUMBIA AVE.)

## Proposed Concept



### Objectives:

- Create a safer pedestrian oriented environment while accommodating both vehicular and pedestrian movements/traffic
- Acknowledge Rose Street as campus gateway

1. Complete street tree planting for a more unified and human scale streetscape
2. Improve pedestrian crossings
3. Upgrade median with groundcover planting or special paving



# SITE 2.1 : ROSE STREET (EUCLID AVE. TO COLUMBIA AVE.)

## Proposed Concept



ROSE STREET : : EUCLID AVE TO COLUMBIA AVE



An aerial photograph of a city grid, overlaid with a semi-transparent blue filter. The image shows a dense pattern of buildings and streets, with a prominent road running diagonally from the top left towards the bottom right. The text is positioned in the lower right quadrant of the image.

# **SITE 2.2:**

**Rose Street : : Columbia Ave. to Huguelet Ave.**



# SITE 2.2: ROSE STREET





# SITE 2.2 : ROSE STREET (COLUMBIA AVE. TO HUGUELET)

Proposed Concept : : Option 1

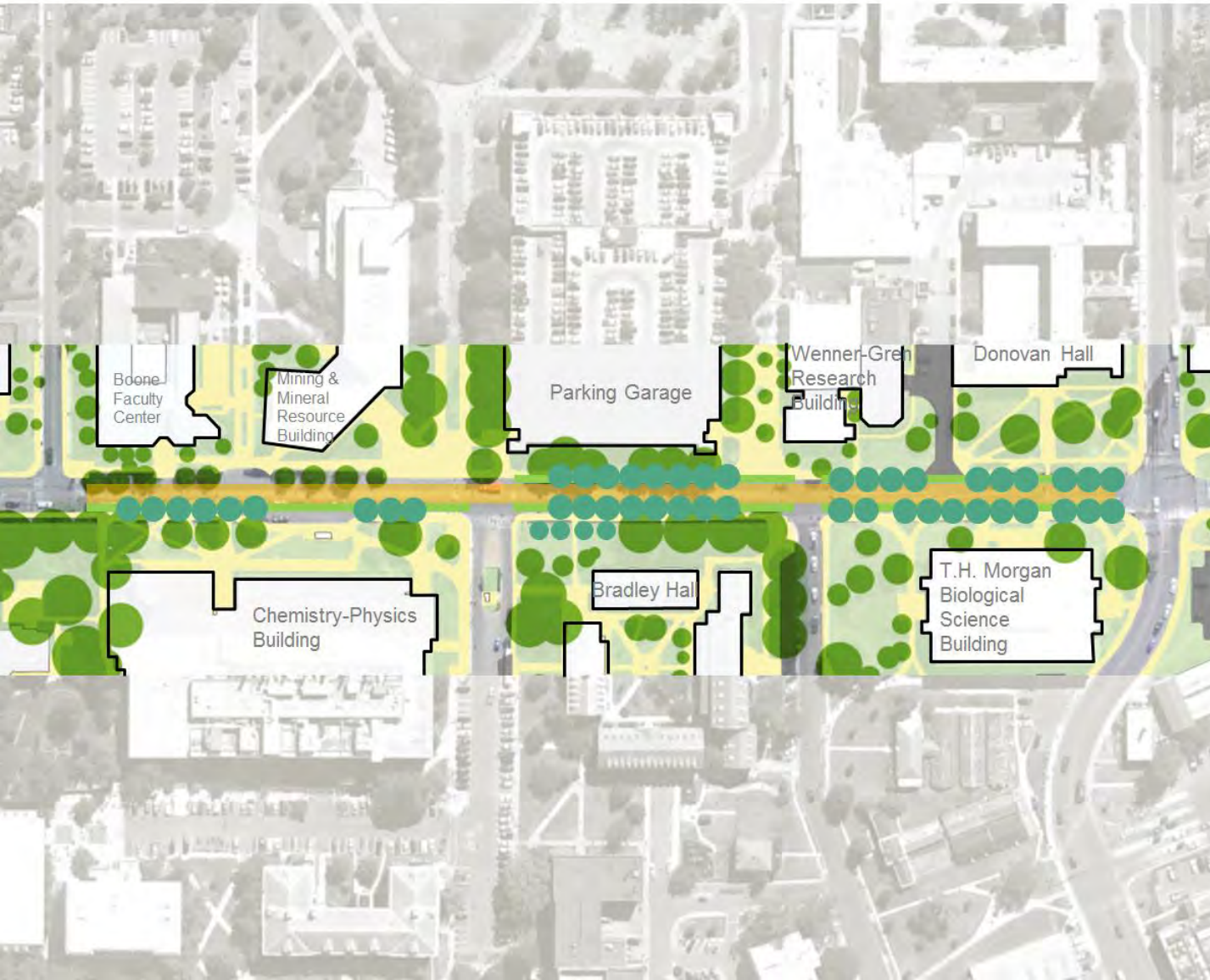

## Objectives:

- **Create a safe pedestrian oriented environment while accommodating both vehicular and pedestrian movements/traffic**
  - **Acknowledge Rose Street as campus gateway**
  - **consider closing to vehicular traffic**
1. Create pedestrian oriented 20' wide service drive and close road to through-traffic
  2. Complete street tree planting for a more unified and human scale streetscape
  3. Raise level of driving lane(s) to be flush with existing curb & sidewalk
  4. Enhance quality of street paving to emphasize pedestrian-oriented use



# SITE 2.2 : ROSE STREET (COLUMBIA AVE. TO HUGUELET)

Proposed Concept : : Option 1

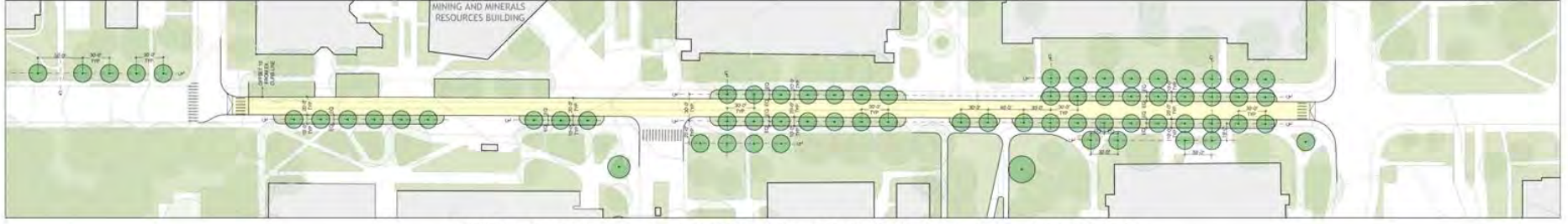

ROSE STREET : : COLUMBIA AVE TO HUGUELET AVE. (OPTION 1)



# STREET SECTION :: ROSE STREET AT FUNKHOUSER DRIVE

Proposed Concept :: Option 1

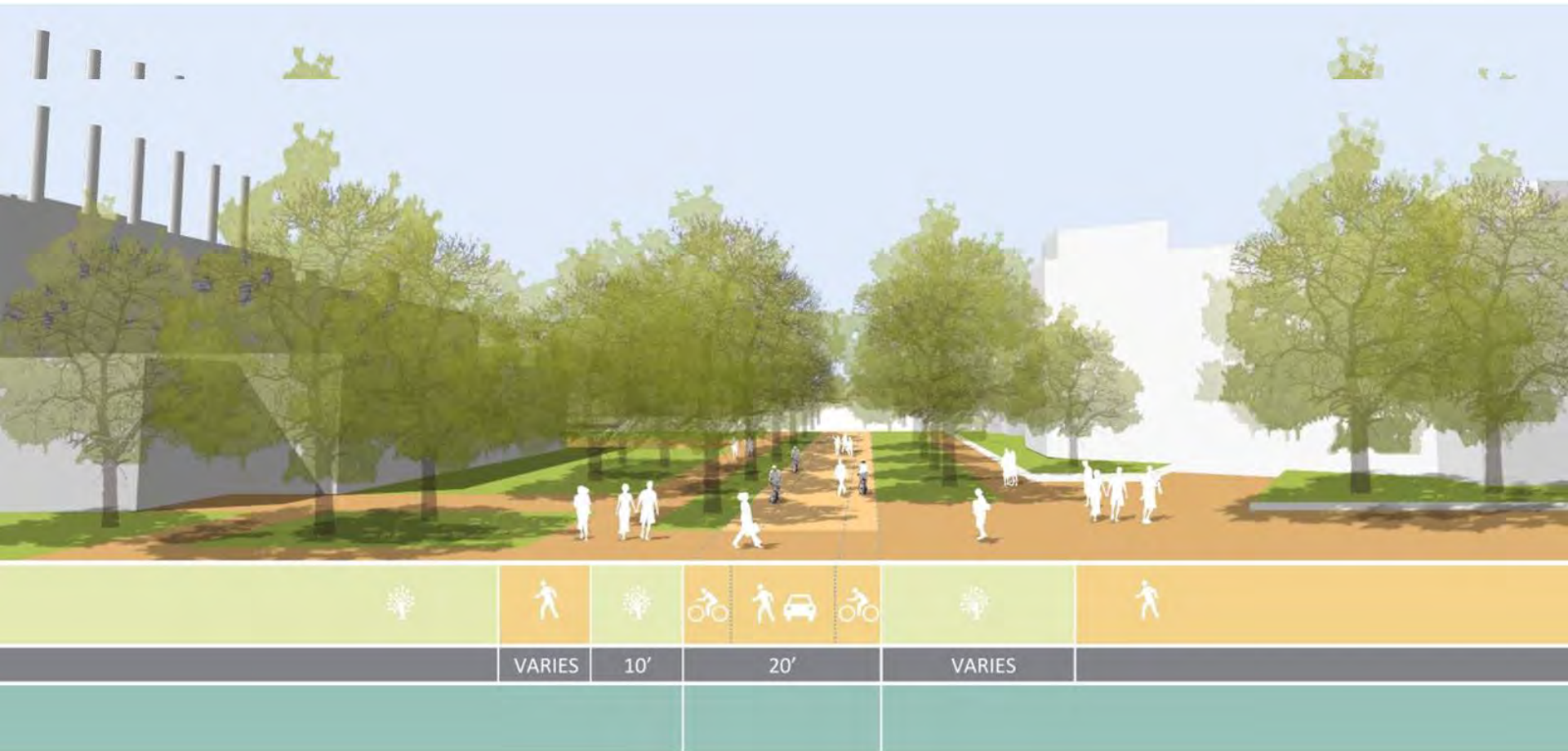



# SITE 2.2 : ROSE STREET (COLUMBIA AVE. TO HUGUELET)

Proposed Concept : : Option 2.1 (road open to through-traffic)

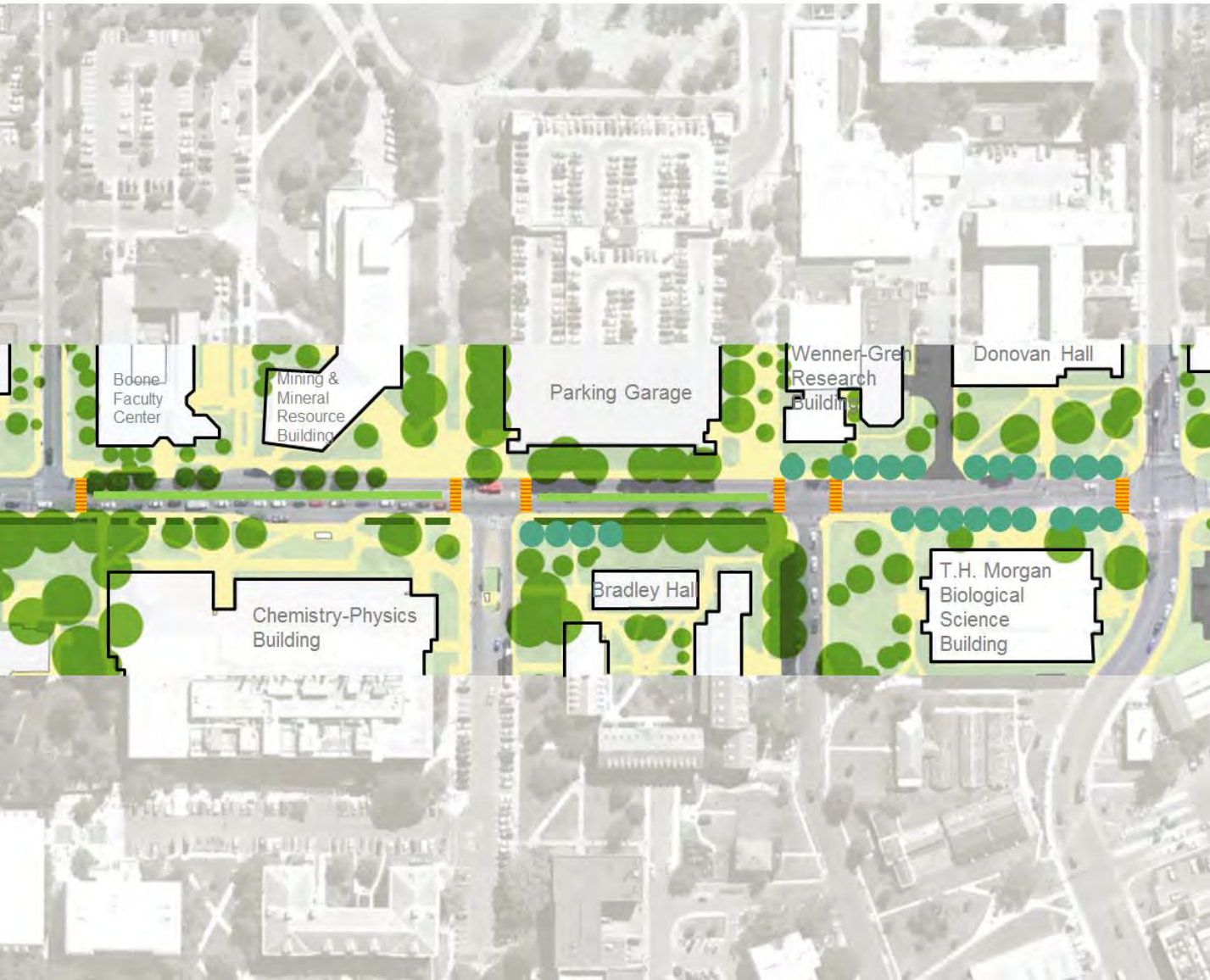

## Objectives:

- **Create a safe pedestrian oriented environment while accommodating both vehicular and pedestrian movements/traffic**
  - **Acknowledge Rose Street as campus gateway**
  - **consider closing to vehicular traffic**
1. Complete rows of existing (street) trees for a more unified and human scale streetscape
  2. Upgrade median with groundcover planting or special paving
  3. Raise level of driving lanes to be flush with existing curb & sidewalk or insert speed tables (optional)
  4. Enhance quality of street paving to emphasize pedestrian-oriented use



# SITE 2.2 : ROSE STREET (COLUMBIA AVE. TO HUGUELET)

Proposed Concept : : Option 2.1 (road open to through-traffic)

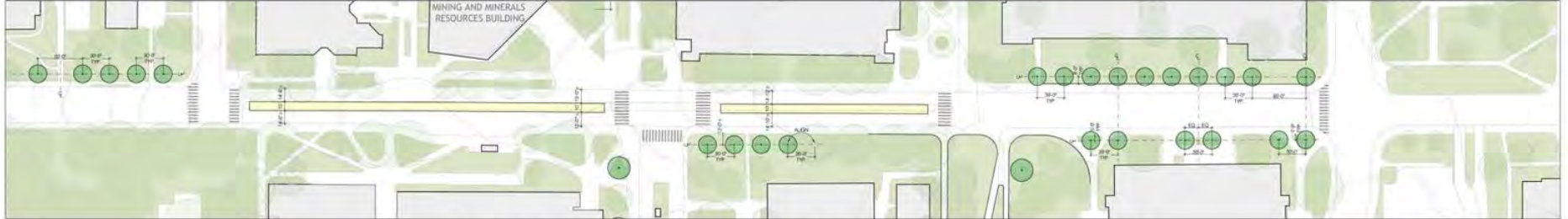

ROSE STREET : : COLUMBIA AVE TO HUGUELET AVE. (OPTION 2.1)



# STREET SECTION :: ROSE STREET AT FUNKHOUSER DRIVE

## Proposed Concept :: Option 2.1

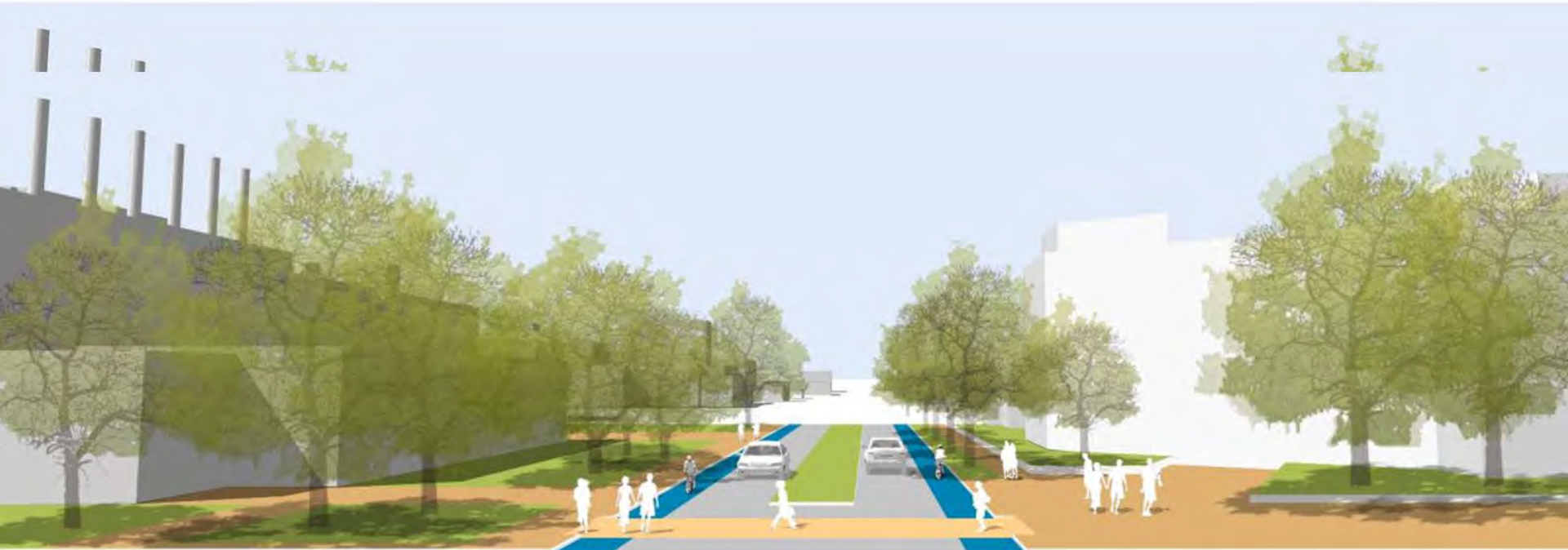



# SITE 2.2 : ROSE STREET (COLUMBIA AVE. TO HUGUELET)

Proposed Concept : : Option 2.2 (road open to through-traffic)

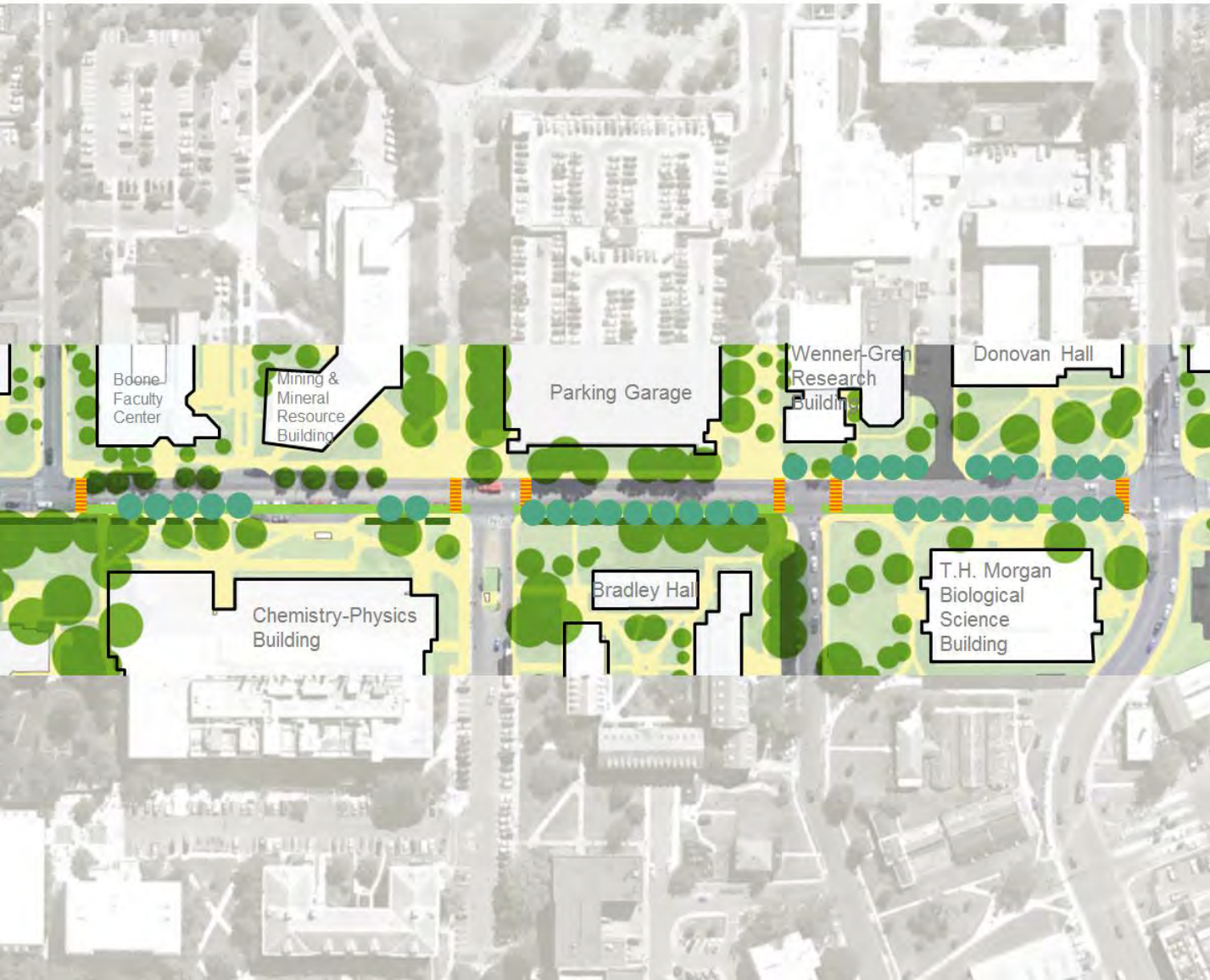

## Objectives:

- **Create a safe pedestrian oriented environment while accommodating both vehicular and pedestrian movements/traffic**
  - **Acknowledge Rose Street as campus gateway**
  - **consider closing to vehicular traffic**
1. Narrow street and add planting and/or sidewalk area along the north side of Rose Street to improve the pedestrian environment
  2. Complete rows of existing (street) trees for a more unified and human scale streetscape
  3. Enhance quality of street paving to emphasize pedestrian-oriented use



# SITE 2.2 : ROSE STREET (COLUMBIA AVE. TO HUGUELET)

Proposed Concept : : Option 2.2 (road open to through-traffic)

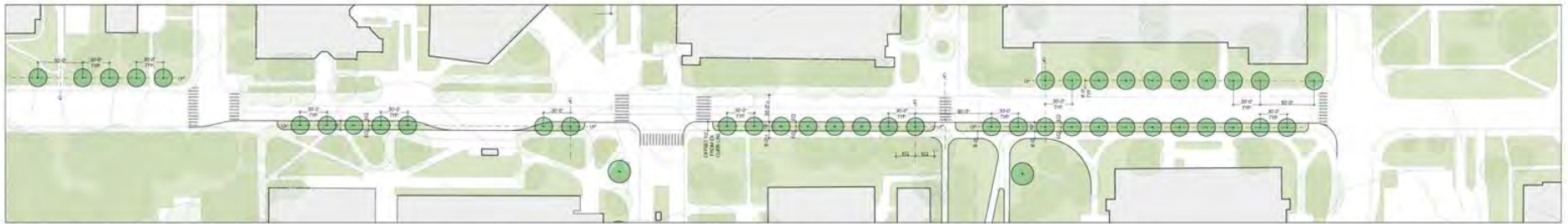

ROSE STREET : : COLUMBIA AVE TO HUGUELET AVE. (OPTION 2.2)



# STREET SECTION : : ROSE STREET AT FUNKHOUSER DRIVE

## Proposed Concept : : Option 2.2

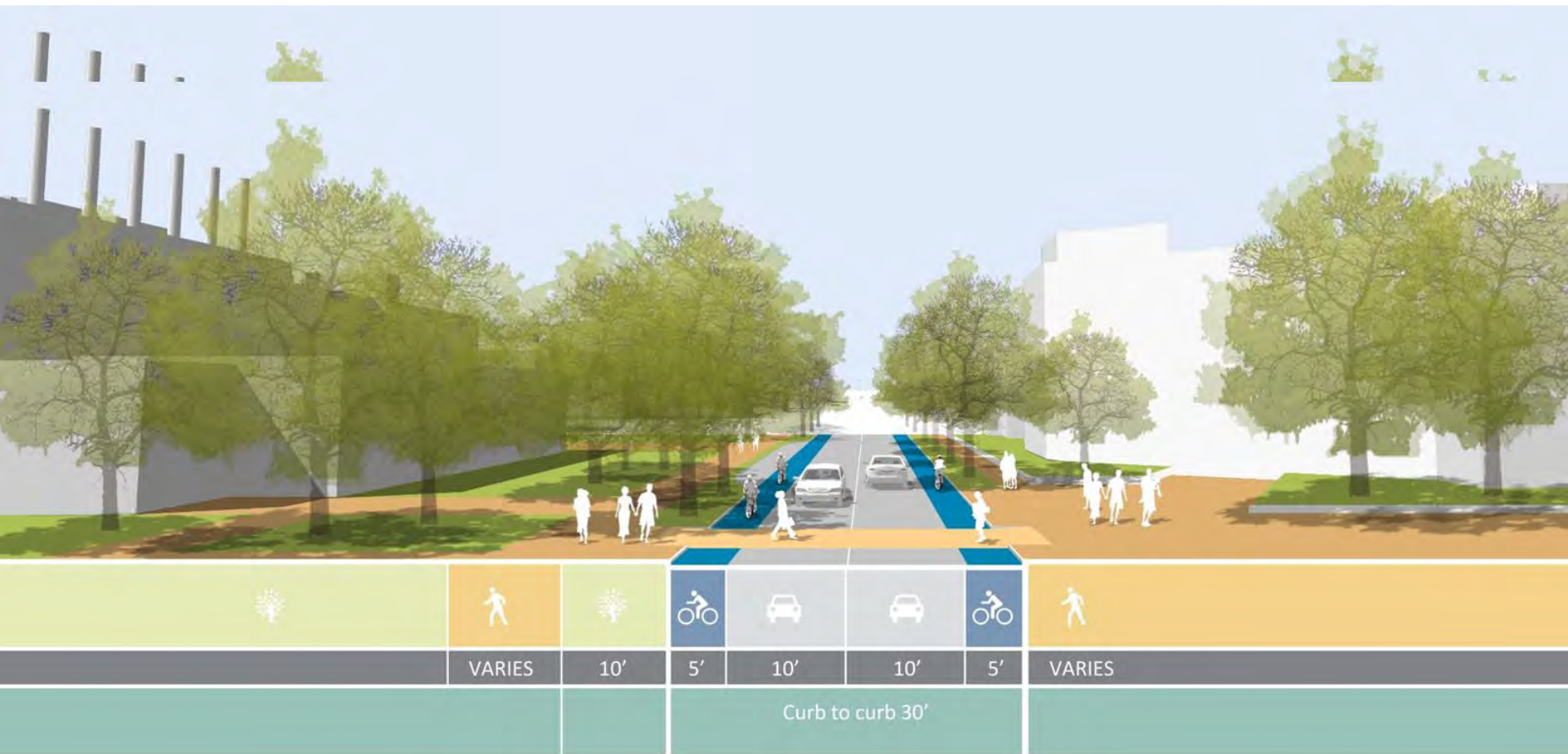





# SITE 3:

Woodland and Hilltop Avenues



SITE 3 : WOODLAND



SITE 3 : WOODLAND





# SITE 3 : WOODLAND AND HILLTOP AVENUES

## Proposed Concept



### Objectives:

- **Emphasize safety for pedestrians**
  - **Connect in character to adjacent residential district**
1. Continue allée-type tree planting from Kirwan Blanding complex along Woodland
  2. Complete tree planting along Hilltop on both sides to frame streetscape
  3. Maintain access to parking lots and introduce special paving on both streets after parking lot entries to indicate pedestrian zone
  4. Consider closing streets from Cooperstown Drive to University Drive



# SITE 3 : WOODLAND AND HILLTOP AVENUES

Proposed Concept

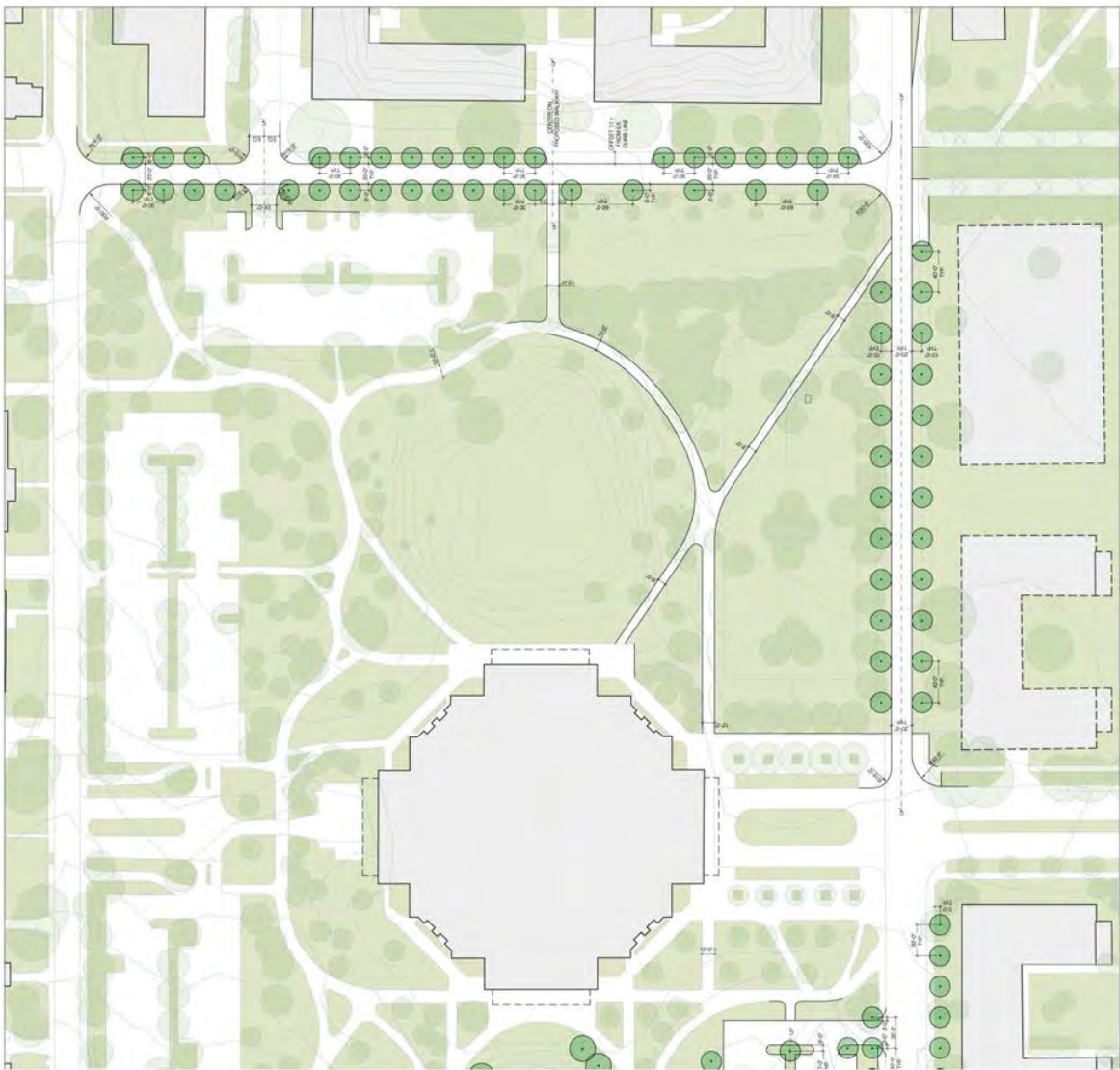



# STREET SECTION : HILLTOP AVENUE

## Existing Conditions

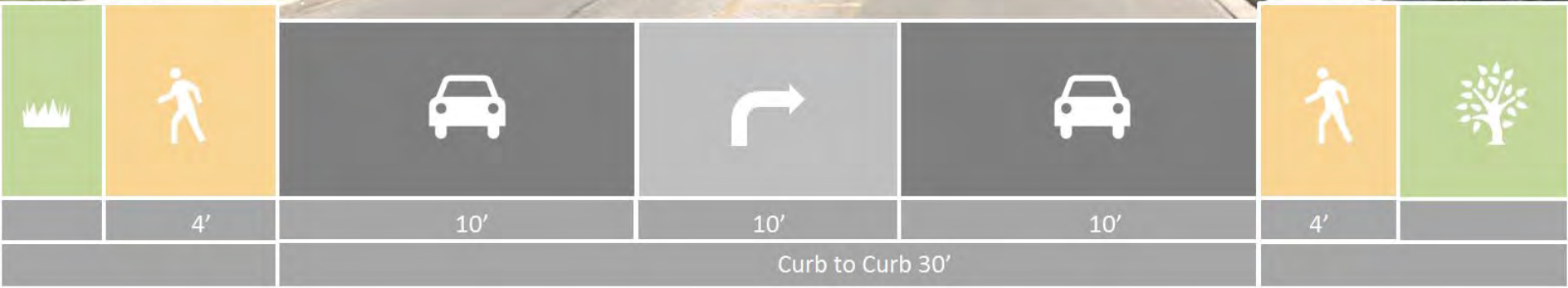



An aerial photograph of a city grid, overlaid with a semi-transparent blue filter. The image shows a dense pattern of buildings and streets, with a prominent diagonal road cutting through the scene. The text is positioned in the lower right quadrant.

# **SITE 4:**

**Funkhouser - Memorial Coliseum : : Pedestrian Spine**



**SITE 4 : NORTH**

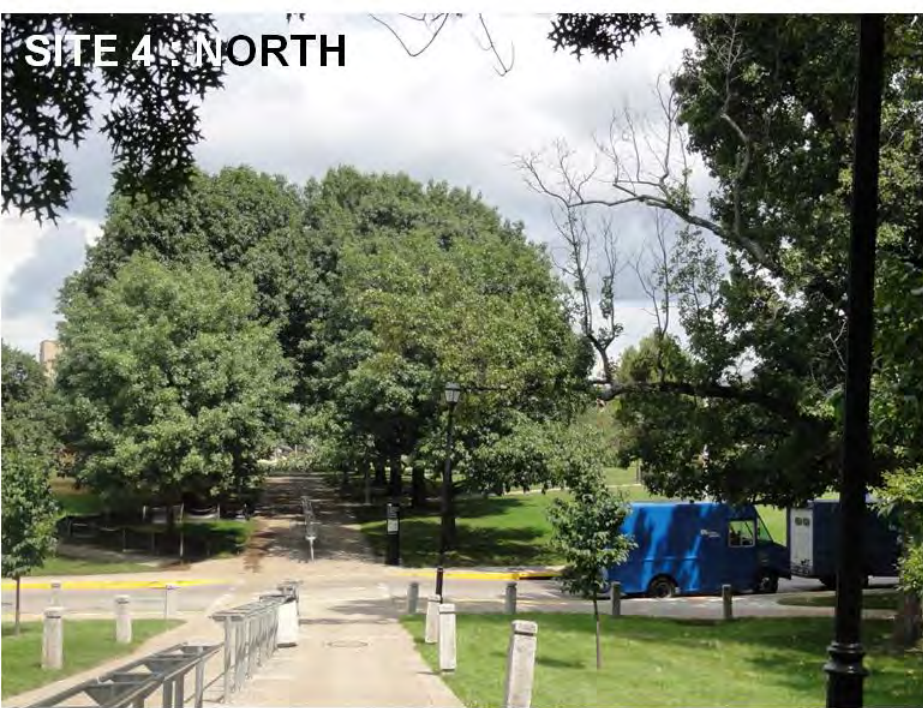

**SITE 4 : CENTRAL**



**SITE 4 : CENTRAL**



**SITE 4 : SOUTH**





# SITE 4 : FUNKHOUSER-MEMORIAL COLISEUM

## Proposed Concept

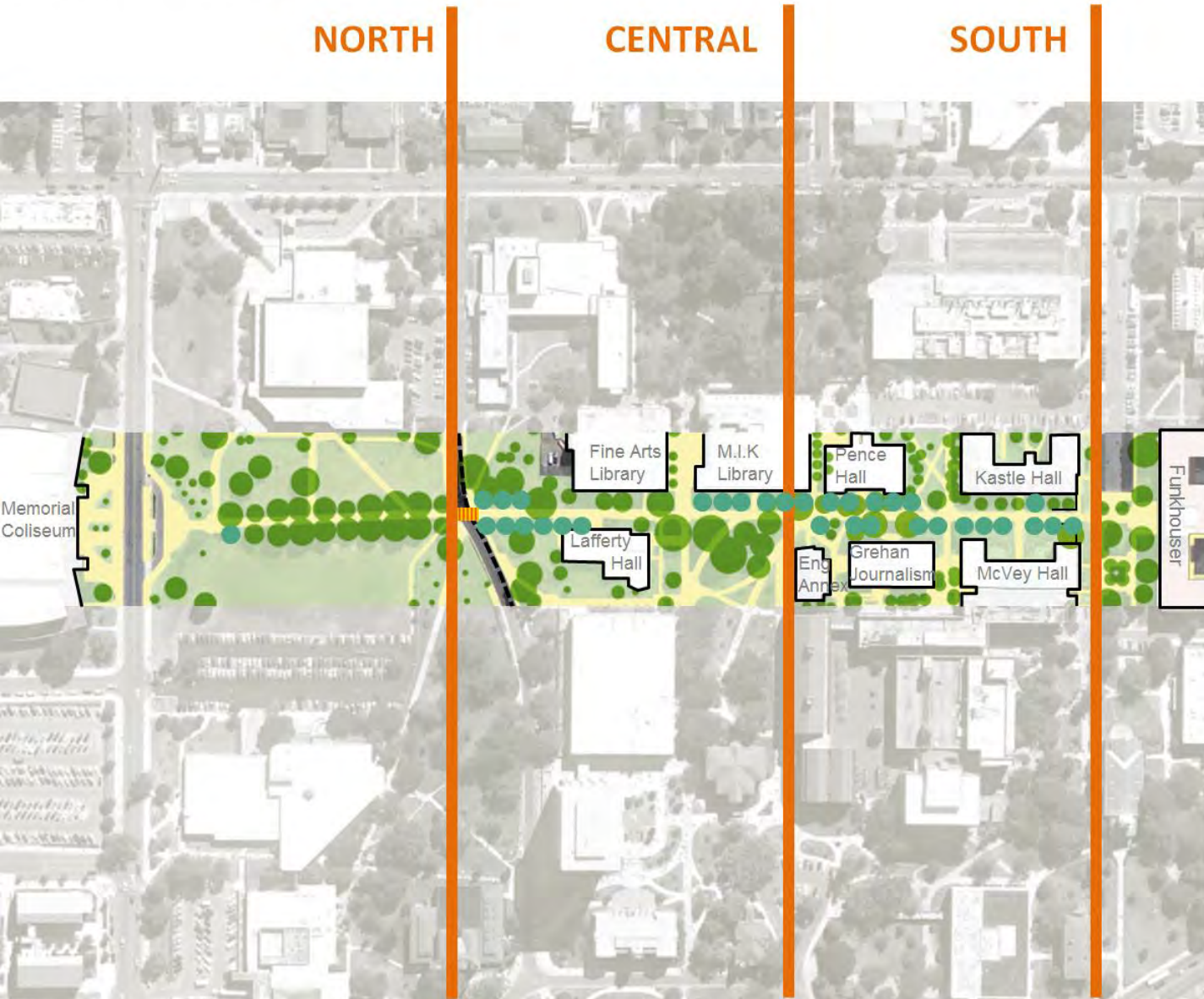

### Objectives:

#### Major pedestrian campus corridor

1. Strengthen linearity with repetitive elements
2. Unify canopy tree planting for full length of this walkway
3. Upgrade quality of handrails and pavements
4. Redesign and simplify entrance and foundation plantings
5. Adjacent courtyards should support character of pedestrian spine

#### NORTH:

- Develop succession plan

#### CENTRAL:

- Remove on-street parking on Patterson Drive
- Replace Japanese Tree Lilac with Honey Locust
- Replace heavy canopy Maples with Honey Locust

#### SOUTH:

- Complete allée with Honey Locust trees



# SITE 4 : FUNKHOUSER-MEMORIAL COLISEUM

## Proposed Concept

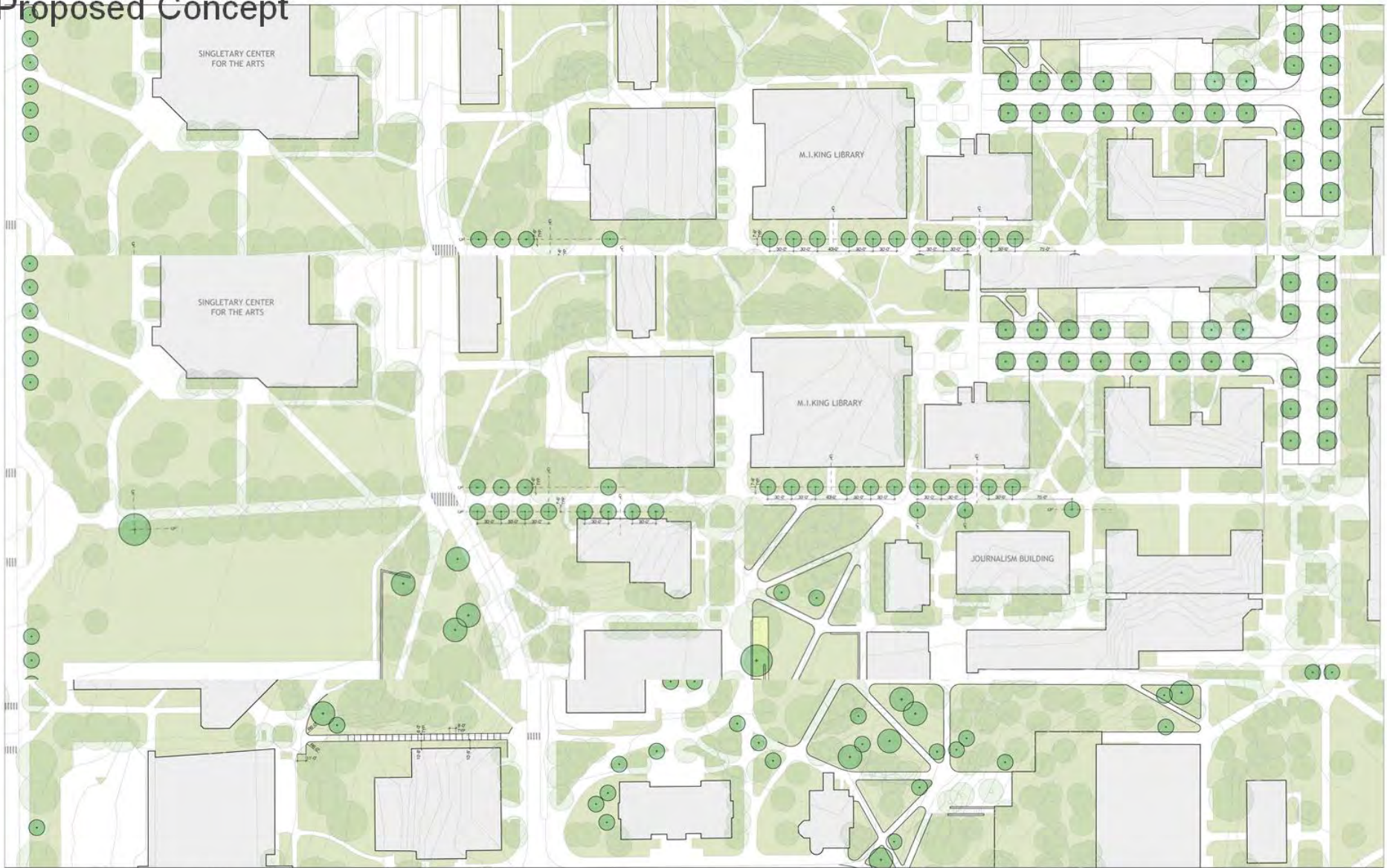





# **SITE 5:**

**Memorial Hall - MLK Boulevard : : Pedestrian Connector**



**SITE 5 : NORTH**



**SITE 5 : CENTRAL**



**SITE 5 : CENTRAL**



**SITE 5 : SOUTH**





# SITE 5 : MEMORIAL HALL-MLK

## Proposed Concept

NORTH

CENTRAL

SOUTH



### Objectives:

- Strengthen movement corridor
- Simplify planting composition to create spatial unity and scale appropriate to the surrounding buildings

### NORTH:

- Align and widen stair/ramp on north side of Botanical Garden
- Improve planting area between walkway and building
- Improve street crossing

### CENTRAL and SOUTH:

- Create simple composition of lawn and canopy trees by replacing small and ornamental with canopy trees
- Eliminate interspersed residential scale 'garden islands'
- Concentrate flower and seasonal plantings at building entries and patios
- Maintain and complement system of pathways along natural desire lines



# SITE 5 : MEMORIAL HALL-MLK

## Proposed Concept

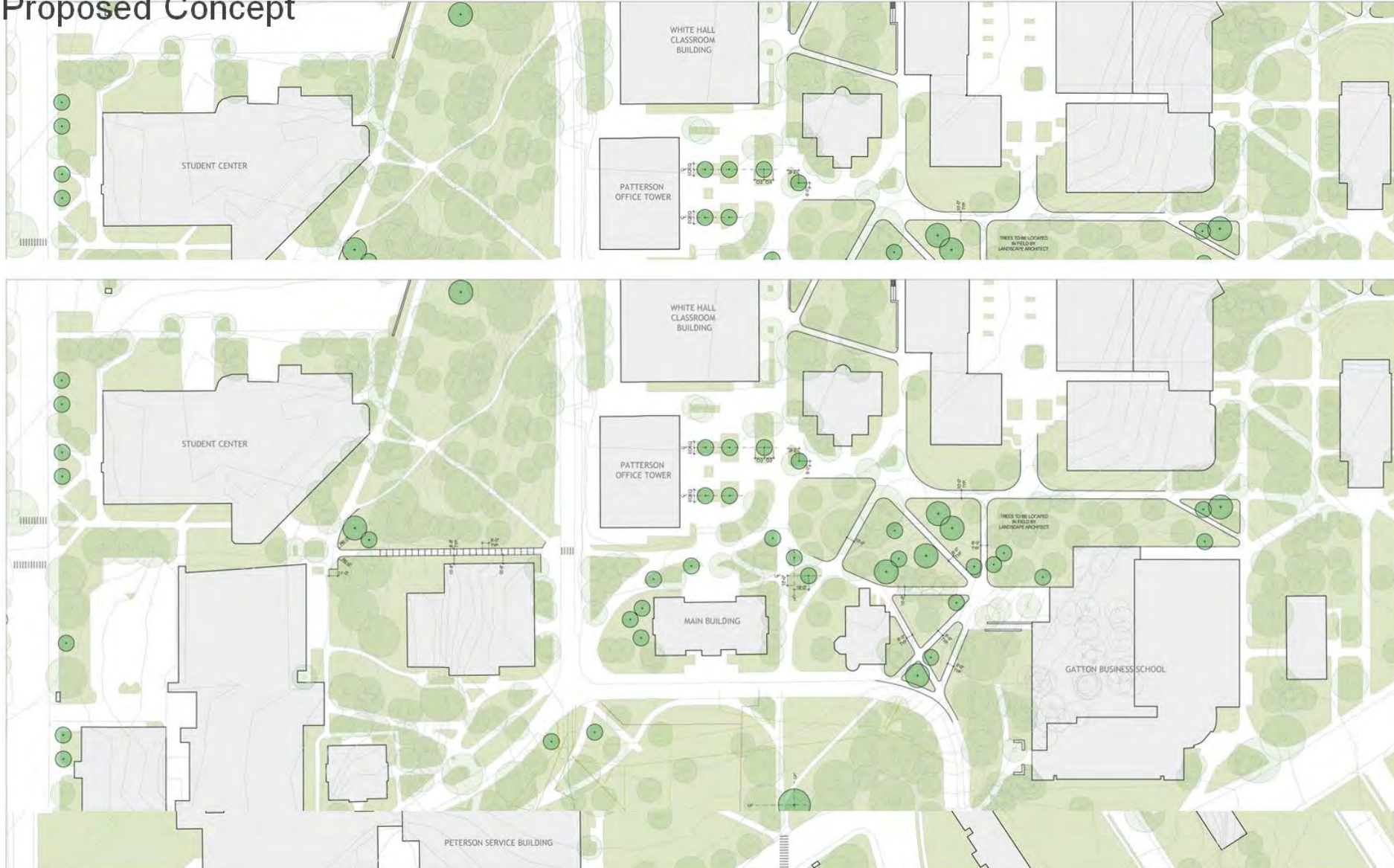





# **SITE 6:**

**Memorial Hall – W.T. Young Library  
Pedestrian Connector**



**SITE 6 : WEST**



**SITE 6 : CENTRAL**



**SITE 6 : WEST**



**SITE 6 : EAST**





# SITE 6 : MEMORIAL HALL – W.T. YOUNG LIBRARY

## Proposed Concept

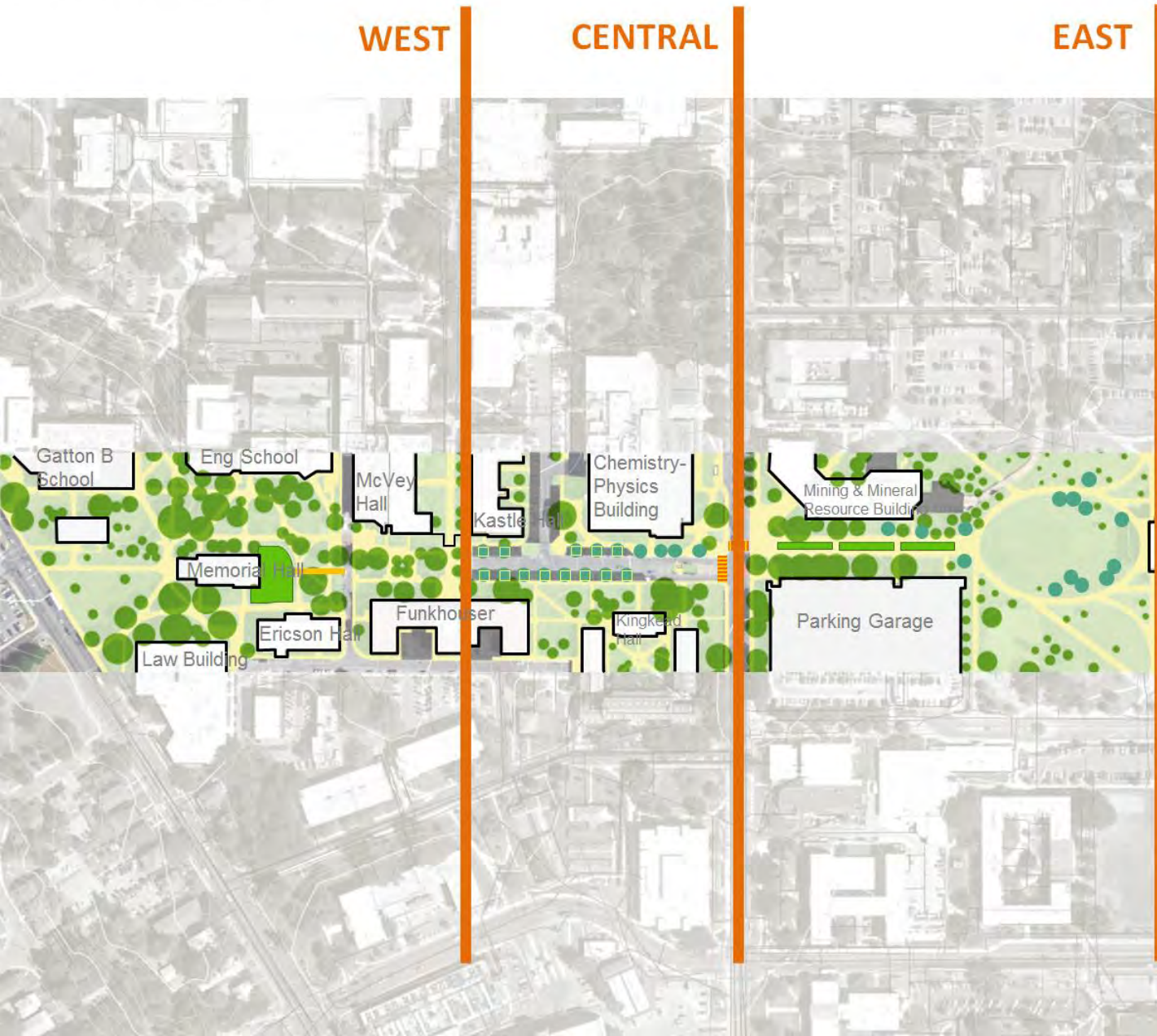

**Objectives:**  
**Visually and spatially connect campus corridor**

Three distinct zones:

### **WEST:**

- Remove surface parking, maintain service access
- Establish clean ground plane under canopy trees to ensure visual connectivity

### **CENTRAL:**

- Create 'parking garden' by alternating double parking spaces with equal size tree planting islands (18'x18')
- Integrate bike parking into the parking space/tree planting pattern in front of Funkhouser
- Improve quality of road paving to indicate pedestrian-oriented zone

### **EAST:**

- Keep median planting clean and simple
- Complete allée of canopy trees
- Complete visual accents with tree grouping in the WT Young Library bowl



# SITE 6 : MEMORIAL HALL – W.T. YOUNG LIBRARY

## Proposed Concept



MEMORIAL HALL TO W.T. YOUNG LIBRARY (MEMORIAL HALL TO ROSE)



MEMORIAL HALL TO W.T. YOUNG LIBRARY (ROSE TO W.T. YOUNG LIBRARY)





# **SITE 7:**

**Taylor Hall – Maxwell Place : : Pedestrian Spine**



SITE 7 : Taylor Hall





# SITE 7: TAYLOR HALL (TAYLOR HALL TO MAIN BUILDING)

## Proposed Concept

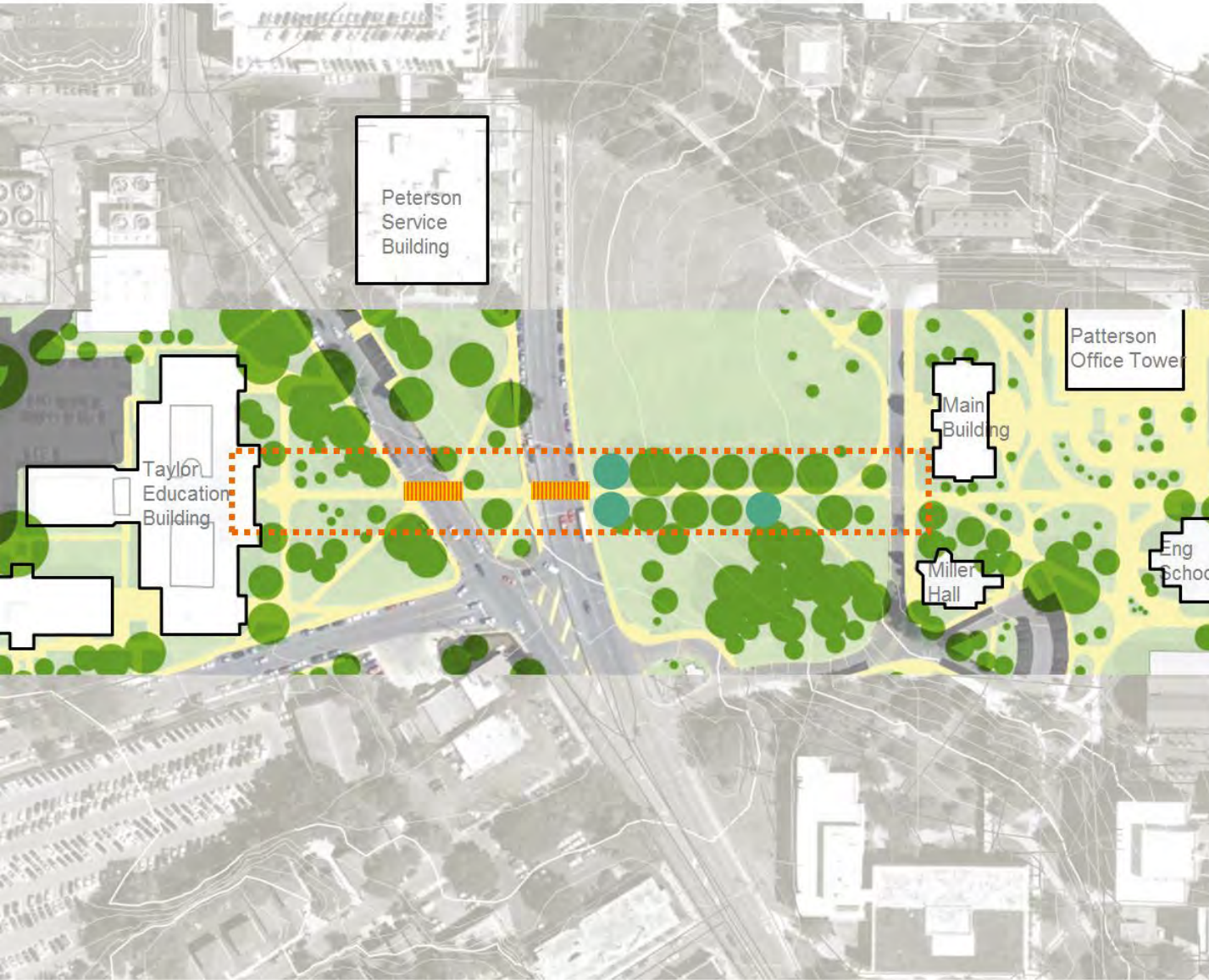

### Objectives:

**Create a more connected campus corridor**

- Complete allée of canopy trees from the Main Building lawn to Limestone
- Maintain informal tree planting in front of the College of Education, limb up trees to 8' height to improve visual connectivity
- Reinforce crossings with special paving



# SITE 7: TAYLOR HALL (TAYLOR HALL TO MAIN BUILDING)

Proposed Concept







# **SITE 8:**

**Central Halls – Funkhouser : : Pedestrian Connector**



SITE 8 : WEST



SITE 8 : CENTRAL



SITE 8 : EAST



SITE 8 : EAST





# SITE 8 : CENTRAL HALLS - FUNKHOUSER

## Proposed Plan

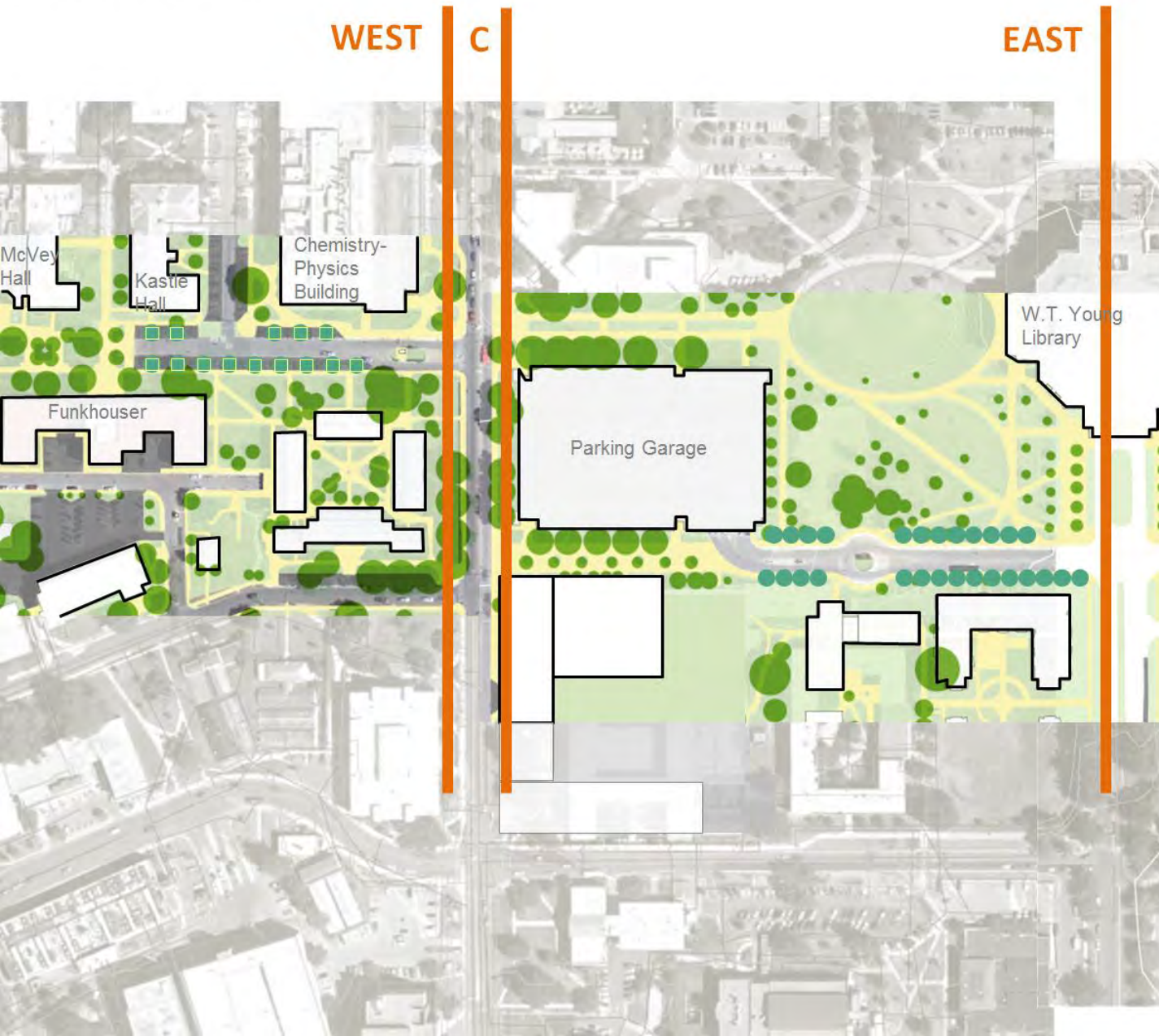

**Objectives: create an interconnected campus corridor experience**

**WEST : : Funkhouser Drive**

- primary entry to academic core of the campus
- Not formally expressed as heavily used pedestrian gateway to the campus

**CENTRAL : : Rose Street: create a safe pedestrian-oriented environment**

- Plant additional street trees to create a more unified streetscape
- Enhance quality of street paving to emphasize pedestrian-oriented use

**EAST : : South of Rose Street (Hilltop Avenue)**

- Introduce street trees along both sides of Hilltop Avenue to create a habitable and attractive walking environment
- Create a safe pedestrian crossing condition at the parking garage entry



# SITE 8 : CENTRAL HALLS - FUNKHOUSER

## Proposed Plan

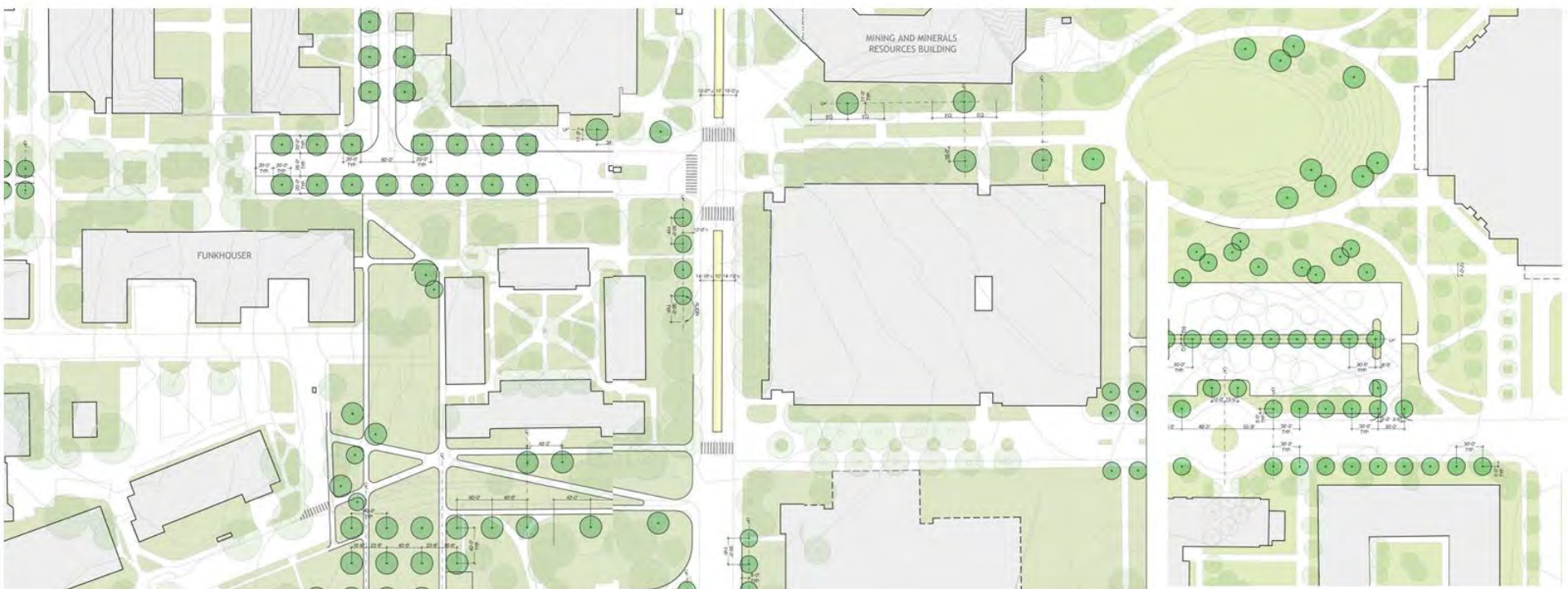





# **SITE 9:**

**College of Agriculture connection to Campus Core**



# SITE 9 : AGRICULTURE – CAMPUS CORE

Existing Conditions





**SITE 9 : Hospital Drive**



**SITE 9 : Veterans Drive**



**SITE 9 : Veterans Drive**



**SITE 9 : Veterans Drive**





# SITE 9 : AGRICULTURE – CAMPUS CORE

## Proposed Concept

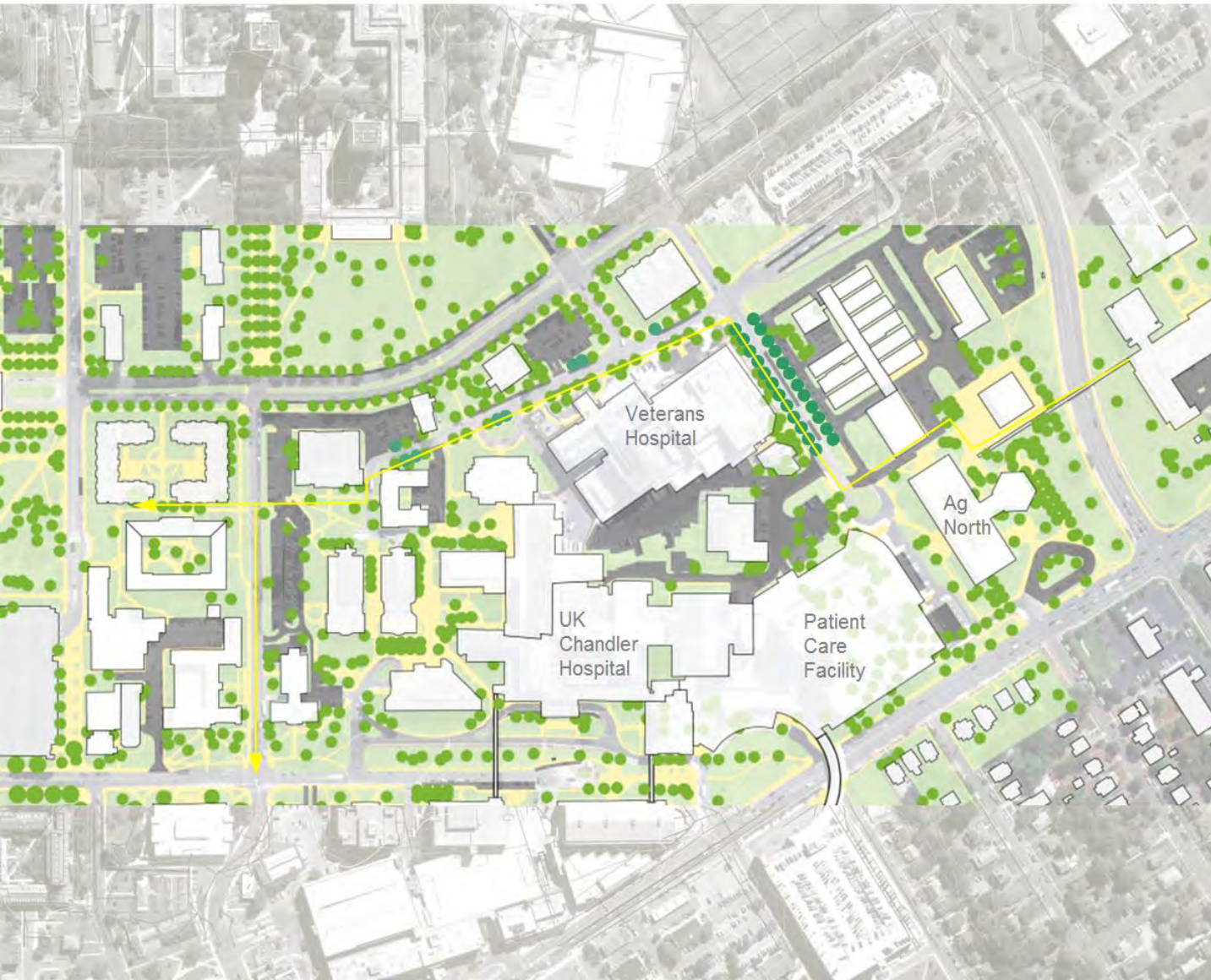

### Objectives:

- Offer more attractive route of travel from the College of Agriculture to the campus core
- Define and encourage new pedestrian movement pattern
- Plant trees along Hospital Drive and Veterans Drive to create a more pedestrian-friendly environment
- Create a safe pedestrian crossing condition
- Encourage shuttle program



# SITE 9 : AGRICULTURE – CAMPUS CORE

Proposed Concept







**SITE 10:**  
**Pennsylvania Court**



SITE 10: Rose Street Plaza



SITE 10: Greek Courtyard



SITE 40: Penn Court



SITE 10: Neighborhood Green





# SITE 10 : PENN COURT

## Proposed Concept

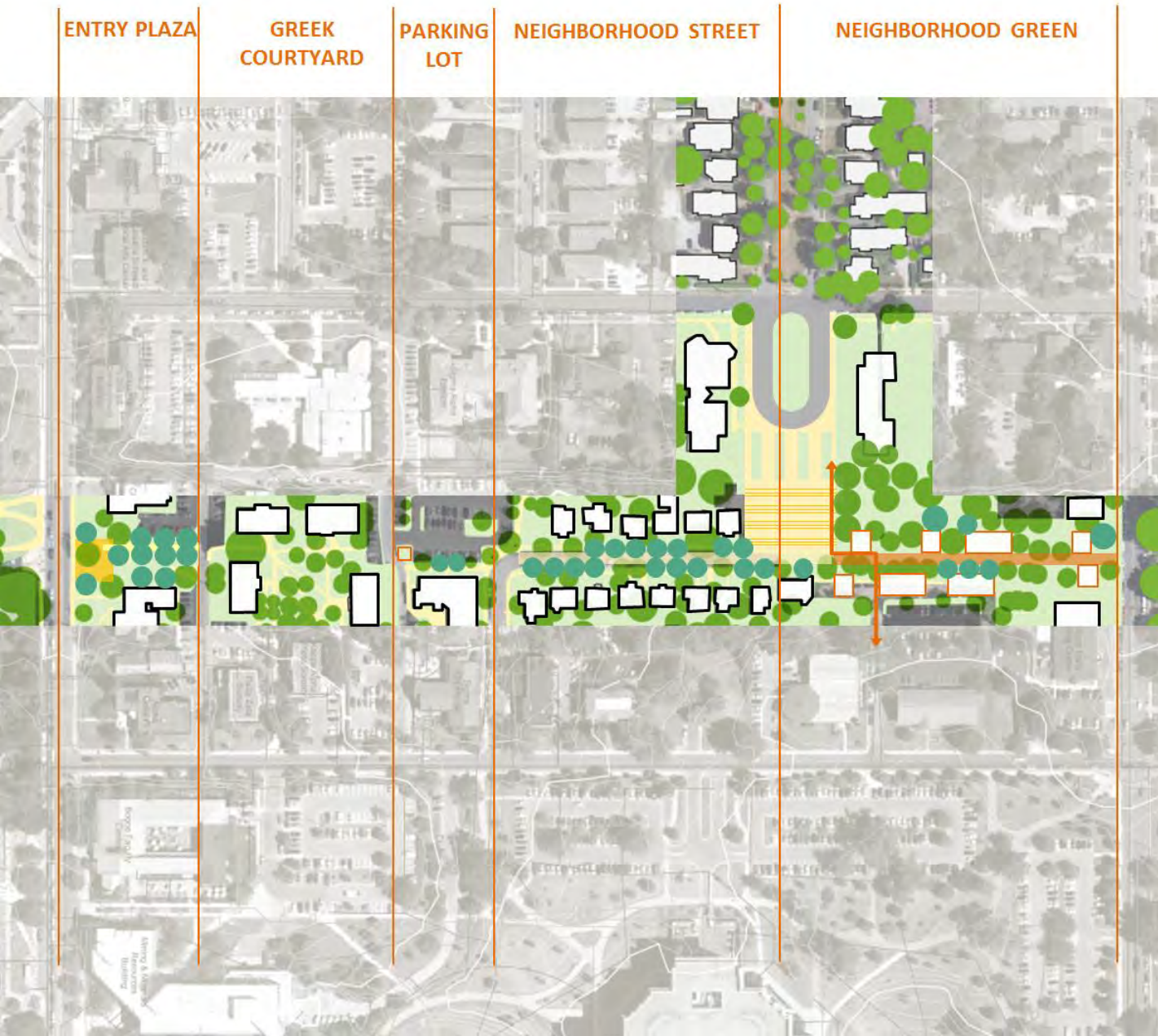

### Objectives:

**Create a more unified pedestrian experience along the pedestrian corridor that provides access across the mega-block**

### Entry Plaza:

Enhance the entry to the Greek Park with a small plaza and a grove of trees

### Greek Courtyard:

Maintain the character of this beautiful intimate courtyard

### Parking Lot:

- Relocate transformer or improve enclosure
- Complete row of trees to help screen the parking lot

### Neighborhood Street:

Maintain residential character and frame with street trees

### Neighborhood Green:

- Provide pedestrian path anchoring the Greek amphitheater to the W.T. Young Library and for future development of the Greek Park
- Infill future Greek housing sensibly to preserve as much of the park-like open space



# SITE 10 : PENN COURT

Proposed Concept



PENNSYLVANIA COURT





# SITE 11:

Main Building Lawn



# SITE 11 : MAIN BUILDING LAWN





# SITE 11 : MAIN BUILDING LAWN

## Proposed Plan



### Objectives:

- Create open space that can be both representative as a memorable visual entry to the campus on Limestone Street
  - Provide open space for everyday activities
  - Frame and screen views into and out of the campus
1. Strengthen tree grove in the north corner of the lawn:
    - to screen view of Peterson service building from the Main Building overlook
    - to provide space for informal recreation while screening activities from Limestone Street



# SITE 11 : MAIN BUILDING LAWN

## Proposed Plan





An aerial photograph of a city grid, overlaid with a semi-transparent blue filter. The image shows a dense pattern of buildings and streets, with a prominent road curving through the lower-left quadrant. The text 'SITE 12: Botanical Garden' is positioned in the bottom right corner.

**SITE 12:**  
Botanical Garden



**SITE 12 : BOTANICAL GARDEN**





# SITE 12 : BOTANICAL GARDEN

## Proposed Concept



### Objectives:

- Foster existing quality of the space
- Enhance unity of space
- Remove all small scale and garden-like plantings to reinforce simplicity of lawn and canopy tree composition
- Add specimen canopy trees as succession trees where appropriate
- Screen concrete retaining wall with planting (hedge or climbers)
- Strengthen (and align) walk along north side
- Provide more seating opportunities in the lawn



# SITE 12 : BOTANICAL GARDEN

## Proposed Concept







# SITE 13:

Whitehall Classroom Building Quad



**SITE 13: WHITEHALL QUAD**





# SITE 13 : THE WHITE HALL QUAD

## Proposed Concept



### Objectives:

- Create open space that functions as a thoroughfare as well as a 'place to be' for social interaction, study or recreation

1. Provide more spaces to sit and linger:
  - Introduce peastone terrace in lawn along Whitehall corridor
  - Turn retaining wall along Anderson into seating steps
1. Remove small ornamental and evergreen
2. Simplify composition of the quad by using only lawn and canopy trees to create a clear spatial composition
3. Reconsider pathway layout to better follow desire lines
4. Replace unhealthy trees with succession planting of large canopy trees



# SITE 13 : THE WHITE HALL QUAD

## Proposed Concept

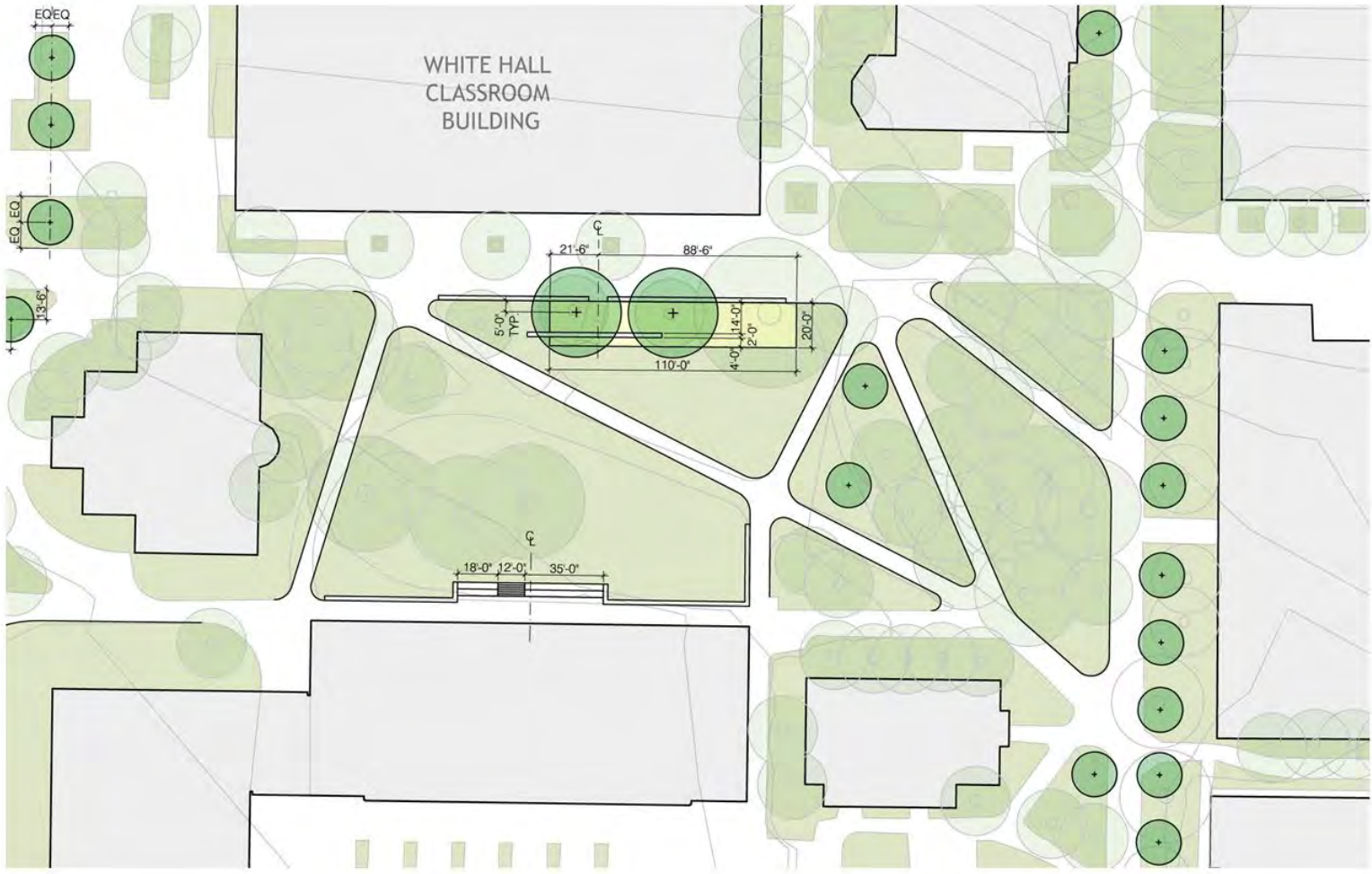





**SITE 14:**  
Library Drive



# SITE 14 : LIBRARY DRIVE





# SITE 14 : LIBRARY DRIVE

## Proposed Concept

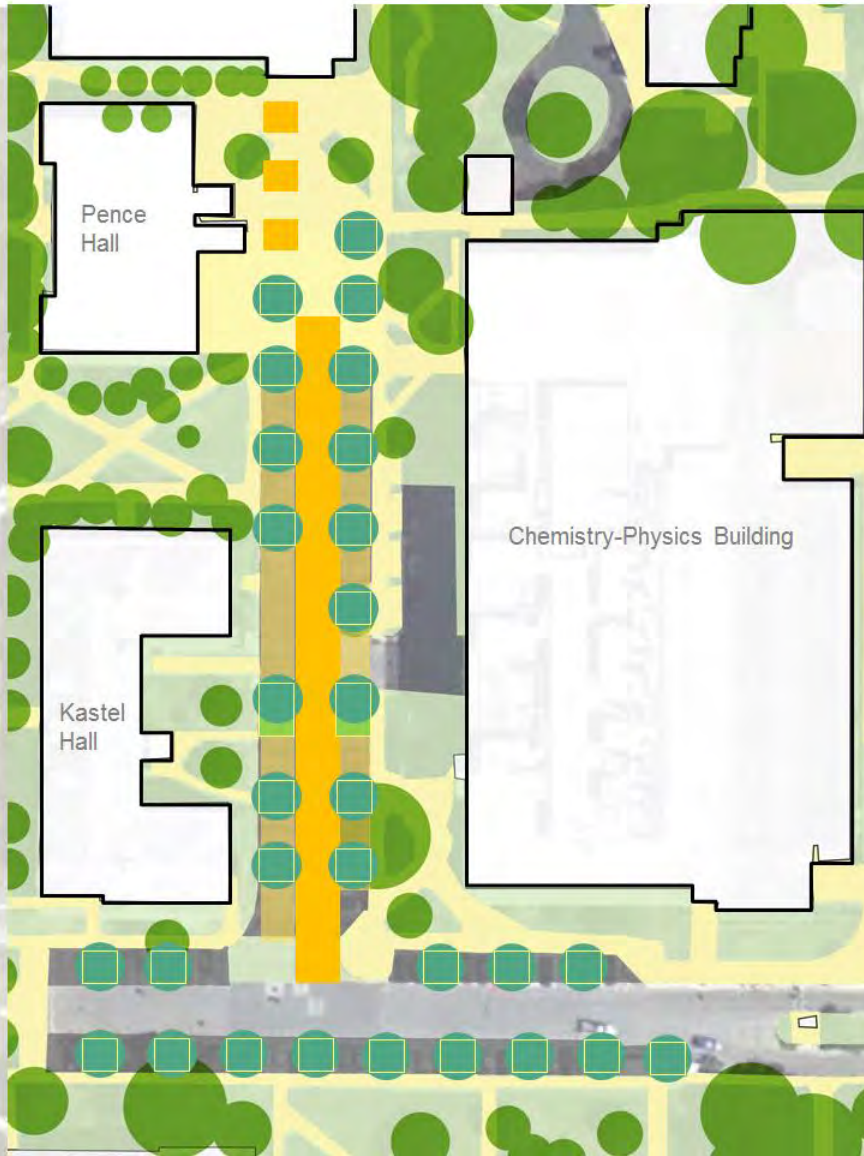

### Objectives:

- **Improve safety and quality of pedestrian experience**
- Create 'parking garden' by alternating double parking spaces with equal size tree planting islands (18'x18')
- Enhance quality of road paving to indicate pedestrian-oriented zone while maintaining access for service and parking
- Provide safe pedestrian crossing at service drive entry
- Mark pedestrian crossings from sidewalk on south side of library drive to building entrances and courtyards on the north side with special paving (continuous sidewalk is not possible on north side)



# SITE 14 : LIBRARY DRIVE

Proposed Concept

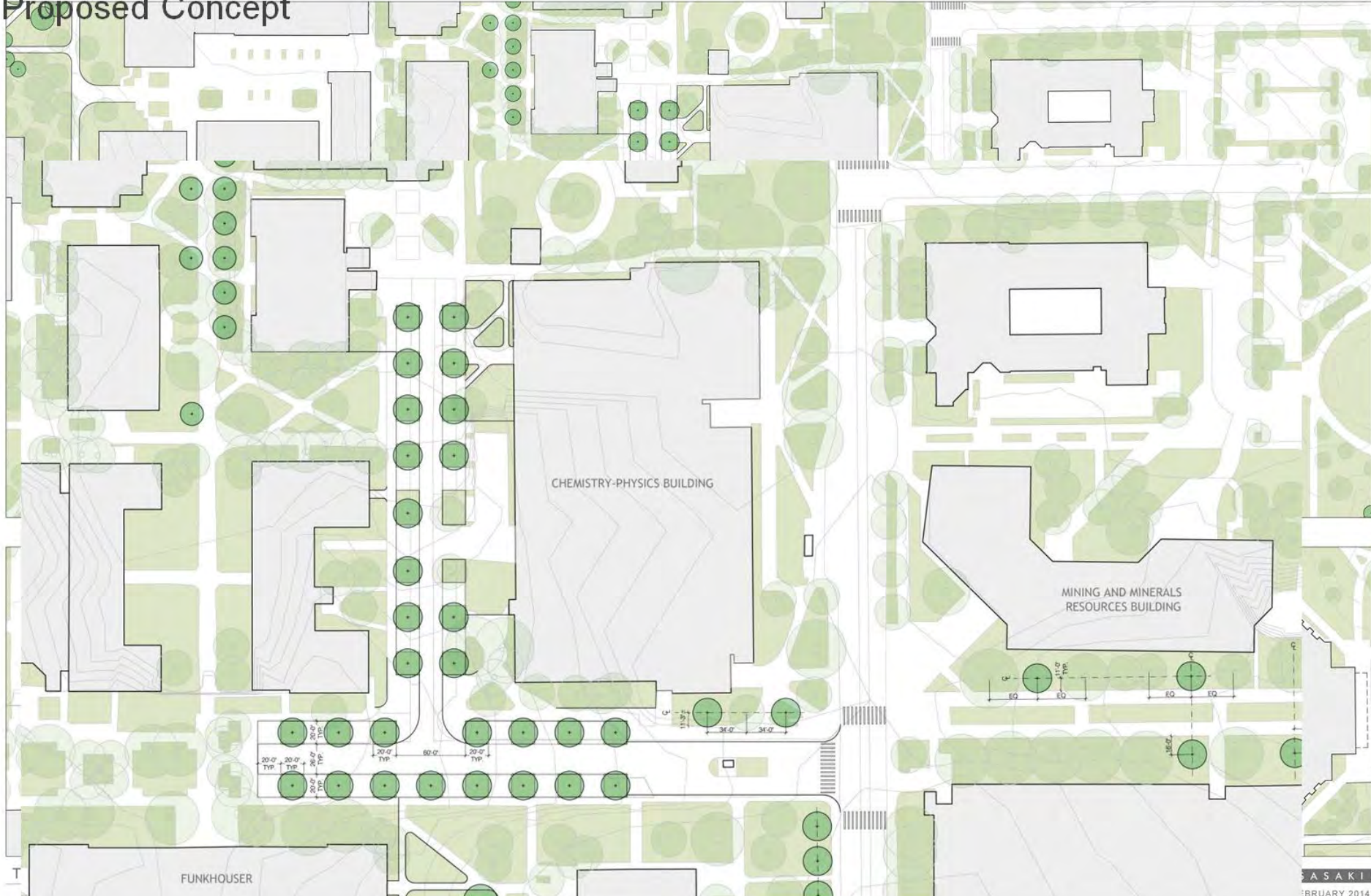





**SITE 15:**  
Alumni Drive



**SITE 15 : ALUMNI DRIVE**  
(looking west)



**SITE 15 : ALUMNI DRIVE**  
(looking east)



**SITE 15 : ALUMNI DRIVE**  
(looking north)



**SITE 15 : ALUMNI DRIVE**  
(looking east)





# SITE 15 : ALUMNI DRIVE

## Proposed Concept

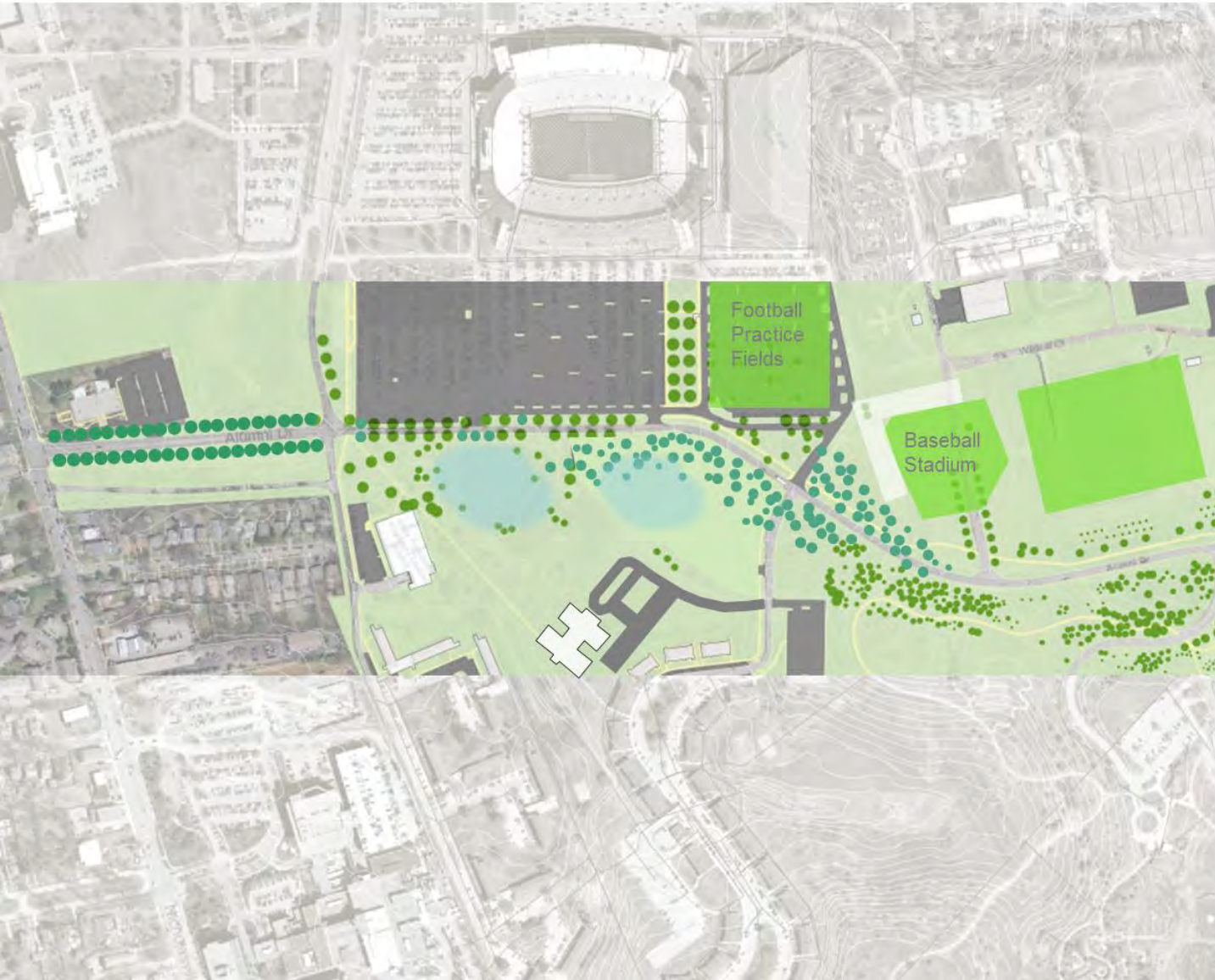

### Objectives: Frame Alumni Drive as a campus gateway

- Signalize intersections to promote better bike and pedestrian crossings; or adopt the most pedestrian-friendly roundabout design
- Build on the existing pattern of tree plantings to create a transition from urban to more park-like experience along the Arboretum
- Consolidate detention basins in open area south of Alumni Drive
- Create a street experience with its own strength and quality that is independent of surrounding developments

### Alumni Drive focus for future improvement:

- Alumni Drive realignment, closer to the existing road, with smoother curves
- 2-lane cross-section



# SITE 15 : ALUMNI DRIVE

## Proposed Concept







**SITE 16:**  
**Washington Street**



**SITE 16: MI King Library**  
(looking north from Library Drive)



**SITE 16 : BRECKINGRIDGE HALL AND  
FUNKHOUSER LAWN**  
(looking south from Library Drive)



**SITE 16 : CHILD CARE PLAYGROUND**  
(looking north from Washington Street)



**SITE 16 : GREENHOUSES**  
(looking north from Washington Street)





# SITE 16 : WASHINGTON STREET AREA

## Proposed Concept

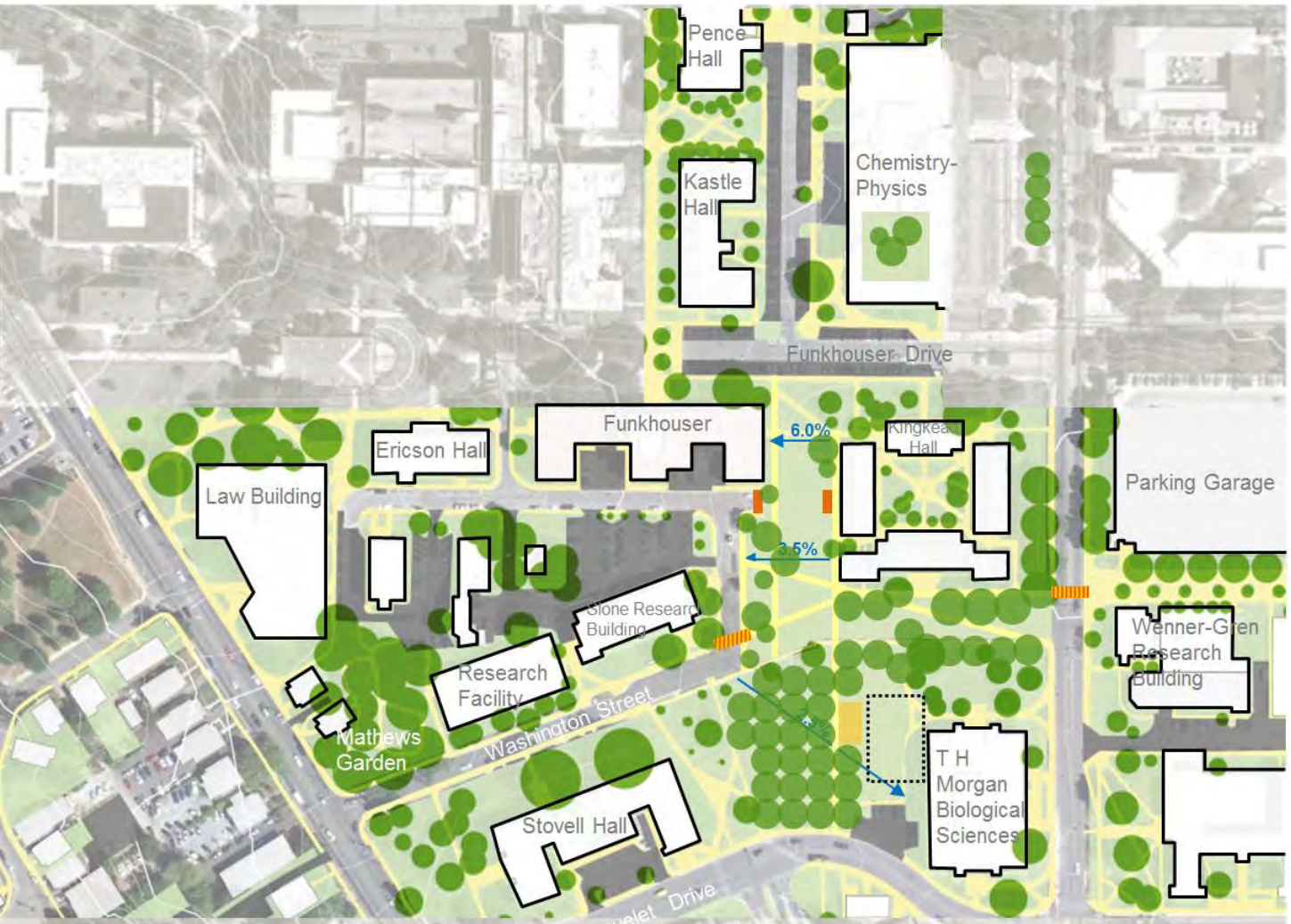

**Objectives:**  
Create a unified and memorable pedestrian and open space experience

Two distinct areas:

**NORTH-SOUTH:**

- Potential shortening of Graham Drive at Gladstone Avenue
- Move dumpster to corner of Funkhouser
- Create a continuous open space with sensible pedestrian connections from Funkhouser Drive to Huguelet Drive
- Keep view shed from M.I. King Library toward Huguelet Drive open up to Washington Street
- Plant 'study grove' between Washington Street and Huguelet Drive

**EAST-WEST:**

- Close the eastern portion of Washington Street (from Rose Street to Gladstone Avenue)
- Create a pleasant walking experience from Central Halls to Washington Street as a new pedestrian entry to the campus core
- Provide safe pedestrian crosswalks



# SITE 16 : WASHINGTON STREET AREA

## Proposed Concept

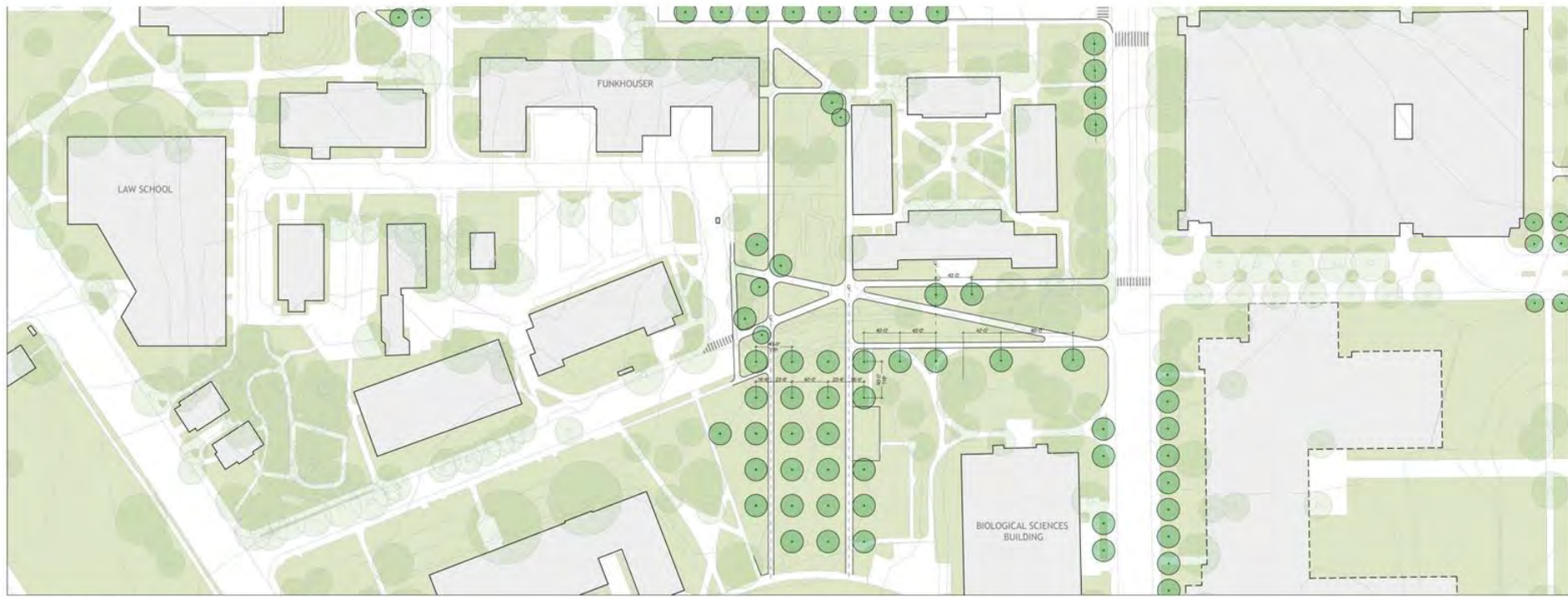



# SITE 16 : WASHINGTON STREET AREA (Near Rose Street)

Existing Conditions

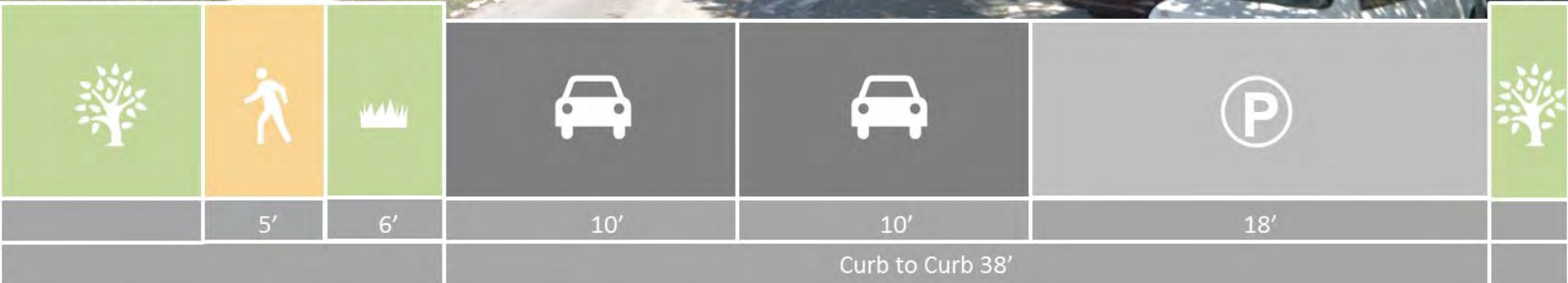



# SITE 16 : WASHINGTON STREET AREA (Near Rose Street)

Proposed Concept

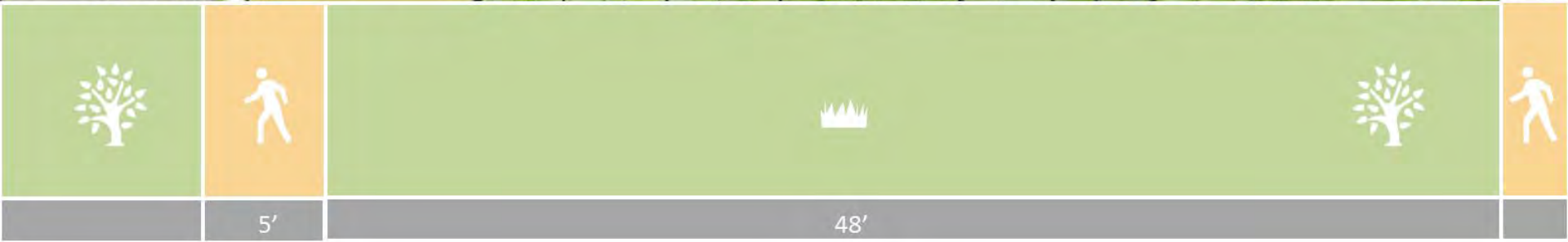



# LANDSCAPE DESIGN VISION

The landscape on the University of Kentucky campus should be designed to function as a “working landscape” that embraces, integrates and embodies design, environmental and academic values. As a complete system, the working landscape responds to the climate and natural conditions of the site, working with its features to maximize their functional qualities. Through sustainable aesthetic and dedication to environmental responsibility emerge a rigor to place-making and a commitment to creating vibrant campus environments. Working landscapes serve as an extension of the educational environment, embracing academic values and utilizing land as an integrated living laboratory.



# LANDSCAPE DESIGN PRINCIPLES

The following tenets should guide the landscape design process and are reflected in the landscape study recommendations:

- Create an identifiable “campus” feeling that is inviting, reinforces the pedestrian environment and supports the University’s mission to provide an intimate, nurturing environment for learning
- Design with the central Kentucky climate in mind
- Enhance and respond to local conditions and ecology as a fundamental design determinant for campus landscape
- Develop a functional landscape that incorporates water conservation, integrates rainwater management into the various landscape and open space elements, and is easy to maintain
- Create outdoor living spaces that promote a strong feeling of community in addition to supporting activities of the University community and contain a system of lively public spaces that provide a hospitable environment for social interaction
- Create a network of shade and comfort zones where people can walk, gather and rest outdoors
- Create an identity and community presence through signature campus gateways and a defined, unified landscape along the public edges of the campus



# GENERAL ISSUES

1. **Overgrown areas around building entrances**
2. **Infill Planting Strategy (Succession)**
3. **Mature Tired Evergreens**
4. **Aging Oaks**
5. **Random plant placement**
6. **Plant selection with regard to tree size, canopy and density**
7. **Definition of landscape areas associated with buildings and the overall campus**
8. **Landscape treatment adjacent to historic structures**
9. **Preservation of key view sheds**



# NEXT STEPS

An aerial photograph of a city grid, overlaid with a semi-transparent blue filter. The image shows a dense pattern of buildings, streets, and green spaces, with a prominent road or canal winding through the lower-left quadrant.

1. Priority Projects
2. Schedule for Design Development